

STATE OF MARYLAND
DEPARTMENT OF GEOLOGY, MINES AND WATER RESOURCES

The Johns Hopkins University
 BALTIMORE 18, MARYLAND

WELL COMPLETION REPORT

This report must be submitted within 30 days after completion of the well

WELL DESCRIPTION

WELL LOG		CASING AND SCREEN RECORD		
State the kind of formations penetrated, their depth, their thickness, and if water-bearing		State the kind and size of casing, liner, shoe, screen, and other accessories (if no casing used, give diameter of well)		
	FERT		DIAM. (Inches)	FERT
	from.....to.....		Am't run	Am't pulled
GW-1509, N.K. Welch #2 Drilled by Columbian Carbon Company. Starting drlg 6-10-52 Comp. drlg. 7-18-52		13-3/8" 40# run at 27'DLM	27' 4"	--
Log of Well		10-3/4" 40# run at 184'DLM with Midget btm. hole packer	183' 4"	--
Slate & Shells 0	180	8-5/8" 24# run at 766'SLM with Mid. btm. hole packer- all pulled	769' 7"	769' 7"
Lime 180	383	7" 23# run at 2733'DLM with 7" shoe	2749' 1"	--
Slate & Shells 383	1534	2-3/8" 4.6# tbq. run with Larkin Modified Upside down packer 2"x6" set at 2732'	3035' 11"	--
766'SLM-761'DLM		F. water 50' - 5 blrs/hr.		
Shale 1534	1596	F. water 146' - 7 blrs/hr.		
Lime, Shell & Slate 1596	1860	Show of gas at 2196'		
Shale 1860	1957	Gas pays: 2880-84'	42/10 W. 7" 23#	2,766,000 cu.ft.
Slate & Shells 1957	2073			
Shale 2073	2221			
Lime 2221	2230			
Slate & Shells 2230	2269			
Shale 2269	2378			
Slate & Shells 2378	2438			
Shale 2438	2660			
Lime 2660	2676			
Shale 2676	2755			
Sandy Lime 2755	2862			
Slate 2862	2879			
Oriskany Sand 2879	3018			
Lime 3018	3047			
TOTAL DEPTH	3047'SLM			

Permit Number 10102
 Name of Owner Columbian Carbon Co.

PUMPING TEST
 Hours Pumped.....
 Pumping Rate
 Gallons per Minute.....

WATER LEVEL
 Distance from land surface to water:
 Before Pumping.....Ft.
 When Pumping.....Ft.

APPEARANCE OF WATER
 Clear.....
 Cloudy.....
 Taste.....
 Odor.....
 Height of Casing Above Land
 SurfaceFt.

PUMP
 Type.....
 Capacity
 Gallons per Minute.....
 Gallons per Hour.....
 Pump Column Length.....Ft.

REMARKS
 Well was shut in on
August 4, 1952.
 Well Was Completed
 Date 8-4-52
 Well Driller A.E. Campbell
Columbian Carbon Co
 Signature

Acidizing record
 7-28-52 - Ran 8 bbls. gasoline followed by 1000 gallons of 10% acid. Displaced with 29 bbls. of water with Tergitol added. Went in on vacuum. Before acid. gas gauged 348 MCF-After 17 hrs. gas gauged 858 MCF.
 7-29-52 - Before reacidizing gas gauged 495 MCF. Ran 8 bbls. gasoline followed by 2000 gallons 15% acid. Displaced with 29 bbls. water with Tergitol added. Final open flow 381,000 cu. ft.

96 hour pressure 610#
 2879
 2133
 146

STATE OF MARYLAND
DEPARTMENT OF GEOLOGY, MINES AND WATER RESOURCES

The Johns Hopkins University
BALTIMORE 18, MARYLAND

12/20/54: Purchased by
Robert L. Price

Oakland

APPLICATION FOR PERMIT TO DRILL WELL

An application must be submitted and permit received before drilling a well
Norris K. Welch #2

Owner.....Columbian Carbon Company.....
Street or R. F. D. Box 873.....
Post Office Charleston 23, W. Va.....

Driller.....A. E. Campbell.....
Street or R. F. D. Post Office Rte #2, Box 7, Oakland, Maryland.....
Date.....May 6, 1952.....

Quantity of Water Needed (G. P. M.).....
Use for Water.....For Drilling Purposes.....
Approximate Depth of Well (feet).....5000'.....
Method of Drilling to be used Cable Tools.....

Location of Well
County.....Garrett.....
Nearest Town Mountain Lake Park.....
Distance from Town.....1.5.....
Direction from Town.....Southwest.....

PERMIT TO DRILL WELL
(Permit to be returned to Driller)

NOT TO BE FILLED IN BY DRILLER

Permit No. 10102

Samples of Cuttings Required by Department Yes No

Owner Requires Permit to Appropriate Water Yes No

Owner Has Permit to Appropriate Water Yes No

The applicant is herewith granted a permit to drill this well subject to the conditions stipulated.

Frank D. Simpson
Director

Date May 9, 1952

Special conditions that may apply:

Samples of cuttings to be taken at every bailing of well

Description of Location of Well

(This information should be definite enough to permit locating well on a county map)

Near what road.....U.S. 219.....
On which side of road.....West.....
(North, East, South, West)
Distance from road.....70 feet.....

Draw a sketch below showing location of well in relation to nearby towns, roads and streams with north in the direction of the arrow.

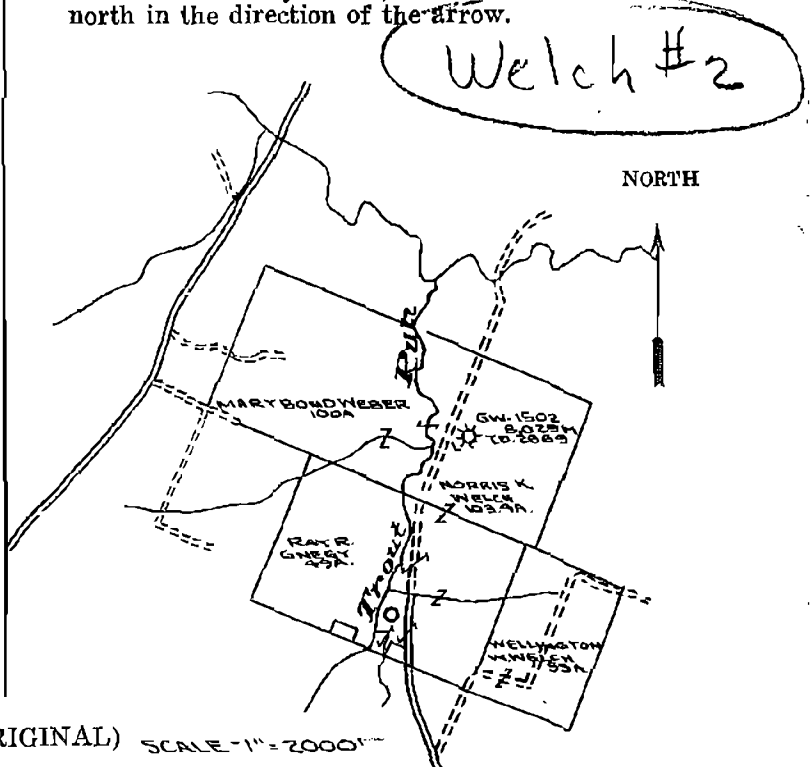

(ORIGINAL) SCALE - 1" = 2000'