

STATE OF MARYLAND
MARYLAND GEOLOGICAL SURVEY
 The Johns Hopkins University
 BALTIMORE, MARYLAND 21218

Permit Number 92
 Well Number 3
 Texas Eastern Transmission Corporation
 Company _____
 County Garrett

COMPLETION REPORT
 (oil or gas well)

This report must be submitted within 30 days after completion of the well

WELL DESCRIPTION - KIND OF WELL: Gas (Storage)
 (Oil, Gas, Other)

NAME & WELL NO.	Size of Casting and Tubing	Used in Drilling	Left in Well	Packers: Type, Size and Depth
Mitchell Rush, Well #3 Mitchell				
ELEVATION: <u>2312 GR.</u> LEASE: <u>Rush</u>	13 3/8"	93'	79'	None
DRILLING COMMENCED: <u>5/2/69</u> DRILLING COMPLETED: <u>5/27/69</u>	9 5/8"	2512'	2496'	None
PRODUCTION: <u>Gas - See Below</u>	7"	7126'	7114'	None 7" Stage Collar @ 6125'.
RESERVOIR PRESSURE <u>Not Measured</u> <u>psig</u> hrs.				
WELL TREATMENT: (Shooting, Acidizing, Fracturing, Etc.)				
See Attached Data				PERFORATIONS AT: Oriskany: Open Hole 7126-7307' Chert: Perf 6990-7006; 7022-26' 7032-38'; 7058-78'
CEMENTING DATA: (Size Pipe, Depth, No. Bags, Date)				
	13 3/8"	93'	150 sx.	5-4-69
	9 5/8"	2512'	550 sx.	5-12-69
	7"	7126'	1st Stage 202 sx.	around bottom casing. 2nd Stage 1600 sx. thru stage collar @ 6125', 5-29-69.
RESERVOIR PRESSURE AFTER TREATMENT:				
Not Measured				
RESULTS AFTER TREATMENT:				
9269 MCFGPD				
REMARKS:	GEOPHYSICAL LOGS (Type of Geophysical Logs Run on Well) Formation Density Gamma Ray - Neutron Induction			

MARYLAND GEOLOGICAL SURVEY

The Johns Hopkins University
BALTIMORE, MARYLAND 21218

GEOLOGICAL LOG

FORMATION	TOP	BOTTOM	GAS AT	OIL AT	WATER AT (Fresh or Salt Water)	REMARKS
Tully Lms.	6256'	6278'				No gas natural in Chert.
1st Onondaga Lms.	6892'	6908'				Encountered following gas
1st Huntersville Chert	6910'	6929'				while drilling Oriskany @
2nd Onondaga Lms.	6942'	6956'				7199' - 660 MCFGD
2nd Huntersville Chert	6960'	7113'				7259' - 713 MCFGD
Needmore Shale	7113'	7165'				TD 7307' - 1467' MCFGD
Oriskany Ss.	7178'	7308'				
Helderberg	7308'					
Total Depth	7307'	Drillers Depth				

This completion report is accurate to the best of my knowledge.

Date November 24, 19 69

APPROVED _____

By Production Manager
(Title)COMPANY Texas Eastern Transmission Corp.

Compl
No. 1969
Gas Storage

State of Maryland
MARYLAND GEOLOGICAL SURVEY
The Johns Hopkins University
Baltimore, Maryland 21218

APPLICATION FOR PERMIT TO DRILL OIL OR GAS WELL

(Applications must be submitted in triplicate)

Mitchell Rush Well #3

OWNER Texas Eastern Transmission Corporation

STREET or R.F.D. _____

POST OFFICE Box 2521

Houston, Texas 77001

PERMIT TO DRILL WELL

NOT TO BE FILLED IN BY APPLICANT

PERMIT NO. 92 - Ninety-Two

The permit is herewith granted subject to the conditions stipulated.

H. N. Weaver
Director

Date April 14, 1969

Special conditions that may apply:

"Gas Storage Well Only"

Names of Drillers must be furnished prior to drilling of well

LOCATION OF WELL

COUNTY Garrett

NEAREST POST OFFICE Accident, Maryland

Distance from Post Office 11,836.34'

Direction from Post Office S. 74° 33' 00" W.

APPROXIMATE DEPTH OF WELL (feet) 7350'

METHOD OF DRILLING Rotary (Air)

DEEPEST GEOLOGIC FORMATION
WELL WILL BE DRILLED into top of Helderberg ls

DISTANCE OF WELL LOCATION
TO NEAREST BUILDING (feet) No buildings
within 1500' of well

NUMBER OF SHIFTS PER DAY Three

LICENSED DRILLER IN CREW OF EACH SHIFT

NAME

ADDRESS

To be furnished

O. Bergh #67

G. Braniff #69

F. Stafford #68

These names may be supplied later but before drilling begins

The names and post office addresses of the owners of the tracts of land included on the plat or map accompanying the application are to be given below.

See attached list

NOTE

A BOND FOR \$2,500 PAYABLE TO THE STATE OF MARYLAND MUST ACCOMPANY THE APPLICATION
THIS APPLICATION FORM MUST BE FILLED OUT WITH TYPEWRITER OR IN BLOCK LETTERS

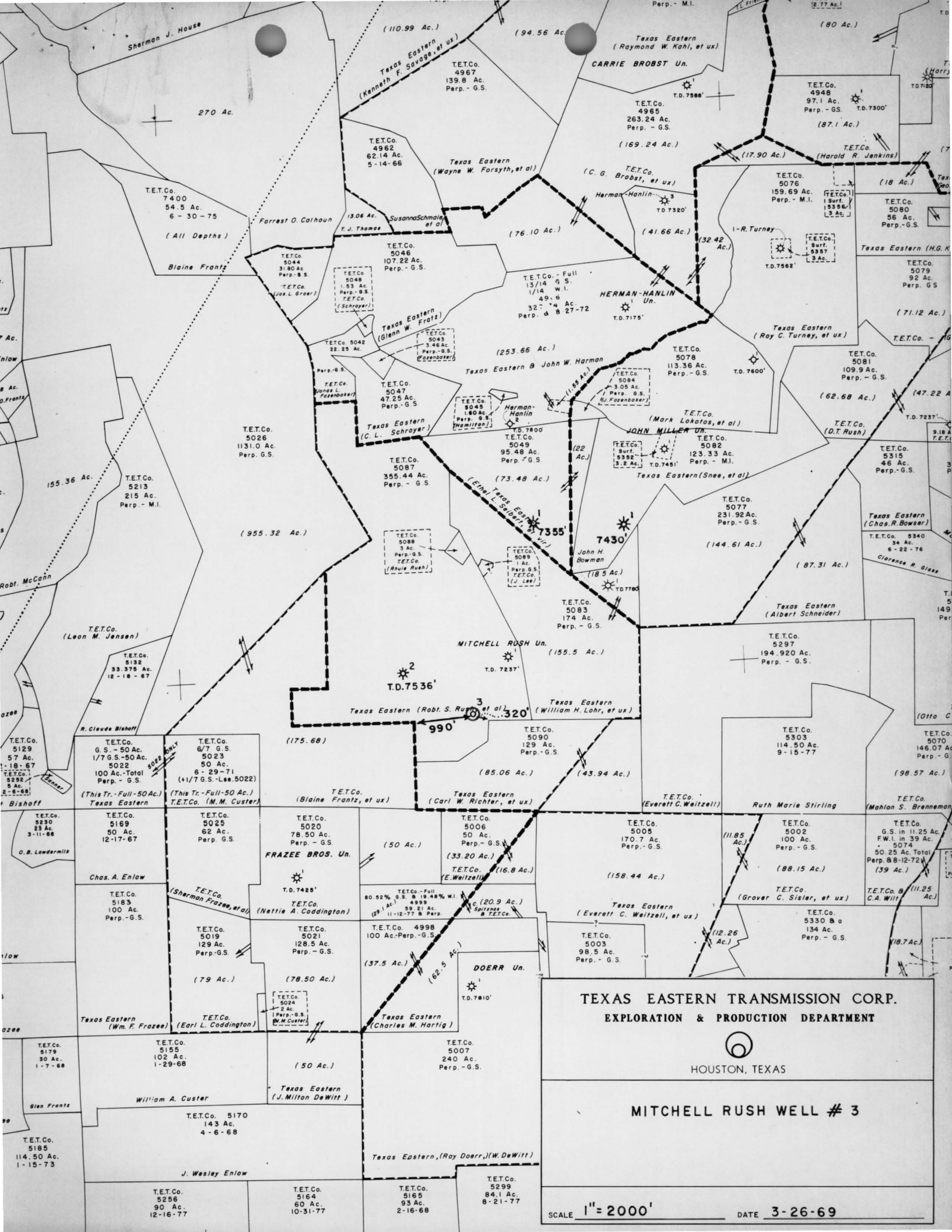

TEXAS EASTERN TRANSMISSION CORP.
EXPLORATION & PRODUCTION DEPARTMENT

HOUSTON, TEXAS

MITCHELL RUSH WELL # 3

SCALE 1" = 2000' DATE 3-26-69