

STATE OF MARYLAND  
**MARYLAND GEOLOGICAL SURVEY**  
 The Johns Hopkins University  
 BALTIMORE, MARYLAND 21218

Permit Number 91

Well Number 1

Texas Eastern Transmission Corporation  
 Company \_\_\_\_\_

County Garrett

**COMPLETION REPORT**

(oil or gas well)

*This report must be submitted within 30 days after completion of the well*

WELL DESCRIPTION - KIND OF WELL: Gas (Storage)  
 (Oil, Gas, Other)

| NAME & WELL NO. Elizabeth Everly, Well #1<br>Elizabeth                | Size of Casting and Tubing | Used in Drilling | Left in Well | Packers: Type, Size and Depth                                                                                      |
|-----------------------------------------------------------------------|----------------------------|------------------|--------------|--------------------------------------------------------------------------------------------------------------------|
| ELEVATION: <u>2346 GR.</u> LEASE: <u>Everly</u>                       | 13 3/8"                    | 105'             | 88'          | None                                                                                                               |
| DRILLING COMMENCED: <u>4/28/69</u> DRILLING COMPLETED: <u>5/28/69</u> | 9 5/8"                     | 2500'            | 2485'        | None                                                                                                               |
| PRODUCTION: <u>Gas - See Below</u>                                    | 7"                         | 7366'            | 7353'        | None                                                                                                               |
| RESERVOIR PRESSURE <u>Not Measured</u> psig _____ hrs.                |                            |                  |              | 7" Stage Collar @ 6190'                                                                                            |
| WELL TREATMENT: (Shooting, Acidizing, Fracturing, Etc.)               |                            |                  |              |                                                                                                                    |
| SEE ATTACHED DATA                                                     |                            |                  |              | PERFORATIONS AT:<br><u>Oriskany</u> : Open Hole 7366 to 7505'<br><u>Chert</u> : Perf. 7064-74' 7012-48' 7210-7112' |

CEMENTING DATA: (Size Pipe, Depth, No. Bags, Date)

13 3/8", 105', 150 sx, 4/28/69

9 5/8", 2500', 500 sx, 5/5/69

7", 7366', 1st Stage 350 sx.

around bottom casing, 2nd Stage 985 sx.

Thru Stage Collar @ 6190, 5/25/69

RESERVOIR PRESSURE AFTER TREATMENT: \_\_\_\_\_

Not Measured

RESULTS AFTER TREATMENT: \_\_\_\_\_

9,000 MCFGPD

REMARKS:

GEOPHYSICAL LOGS (Type of Geophysical Logs Run on Well)

Formation Density  
 Gamma Ray Neutron  
 Induction

## MARYLAND GEOLOGICAL SURVEY

The Johns Hopkins University  
BALTIMORE, MARYLAND 21218

## GEOLOGICAL LOG

| FORMATION          | TOP   | BOTTOM | GAS AT | OIL AT | WATER AT<br>(Fresh or<br>Salt Water) | REMARKS                   |
|--------------------|-------|--------|--------|--------|--------------------------------------|---------------------------|
| Tully Lms          | 6286' | 6335'  |        |        |                                      | No gas in Chert Natural   |
| Onondaga Lms       | 6979' | 7000'  |        |        |                                      | Oriskany tested gas @ 250 |
| Huntersville Chert | 7004' | 7222'  |        |        |                                      | MCFGD from 7440' - 50'.   |
| 1st Needmore Shale | 7222' | 7259'  |        |        |                                      |                           |
| 2nd Needmore Shale | 7259' | 7300'  |        |        |                                      |                           |
| 3rd Needmore Shale | 7300' | 7370'  |        |        |                                      |                           |
| Oriskany Ss.       | 7370' | 7504'  |        |        |                                      |                           |
| Helderberg Lms.    | 7504' |        |        |        |                                      |                           |
| TOTAL DEPTH        | 7505' |        |        |        |                                      |                           |

This completion report is accurate to the best of my knowledge.

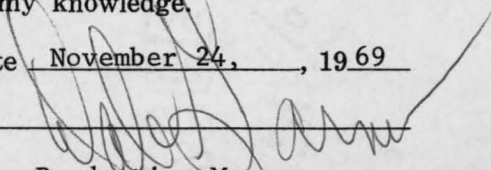
Date November 24, 1969APPROVED By Production Manager  
(Title)COMPANY Texas Eastern Transmission Corp.

State of Maryland  
MARYLAND GEOLOGICAL SURVEY  
The Johns Hopkins University  
Baltimore, Maryland 21218

Compl  
Nov 1969  
gas storage 91

APPLICATION FOR PERMIT TO DRILL OIL OR GAS WELL

(Applications must be submitted in triplicate)

Elizabeth Everly #1

OWNER Texas Eastern Transmission Corporation

STREET or R.F.D. \_\_\_\_\_

POST OFFICE Box 2521

Houston, Texas 77001

PERMIT TO DRILL WELL

NOT TO BE FILLED IN BY APPLICANT

PERMIT NO. Ninety-One - 91

The permit is herewith granted subject to the conditions stipulated.

H. N. Weaver  
Director

Date April 14, 1969

Special conditions that may apply:

"Gas Storage Well Only"

Names of Drillers must be furnished  
prior to drilling of well

LOCATION OF WELL

COUNTY Garrett

NEAREST POST OFFICE Accident, Maryland

Distance from Post Office 12,033.60'

Direction from Post Office N. 4° 10' 49" W.

APPROXIMATE DEPTH OF WELL (feet) 7290'

METHOD OF DRILLING Rotary (Air)

DEEPEST GEOLOGIC FORMATION

WELL WILL BE DRILLED into top of Helderberg Ls

DISTANCE OF WELL LOCATION

TO NEAREST BUILDING (feet) No buildings

within 1500' of well

NUMBER OF SHIFTS PER DAY Three

LICENSED DRILLER IN CREW OF EACH SHIFT

NAME

ADDRESS

To be furnished

R. L. Middlebrough # 70 D. Johnston # 72

R. L. Morgan # 71

These names may be supplied later but before drilling begins

The names and post office addresses of the owners of the tracts of land included on the plat or map accompanying the application are to be given below.

See attached list

NOTE

A BOND FOR \$2,500 PAYABLE TO THE STATE OF MARYLAND MUST ACCOMPANY THE APPLICATION  
THIS APPLICATION FORM MUST BE FILLED OUT WITH TYPEWRITER OR IN BLOCK LETTERS



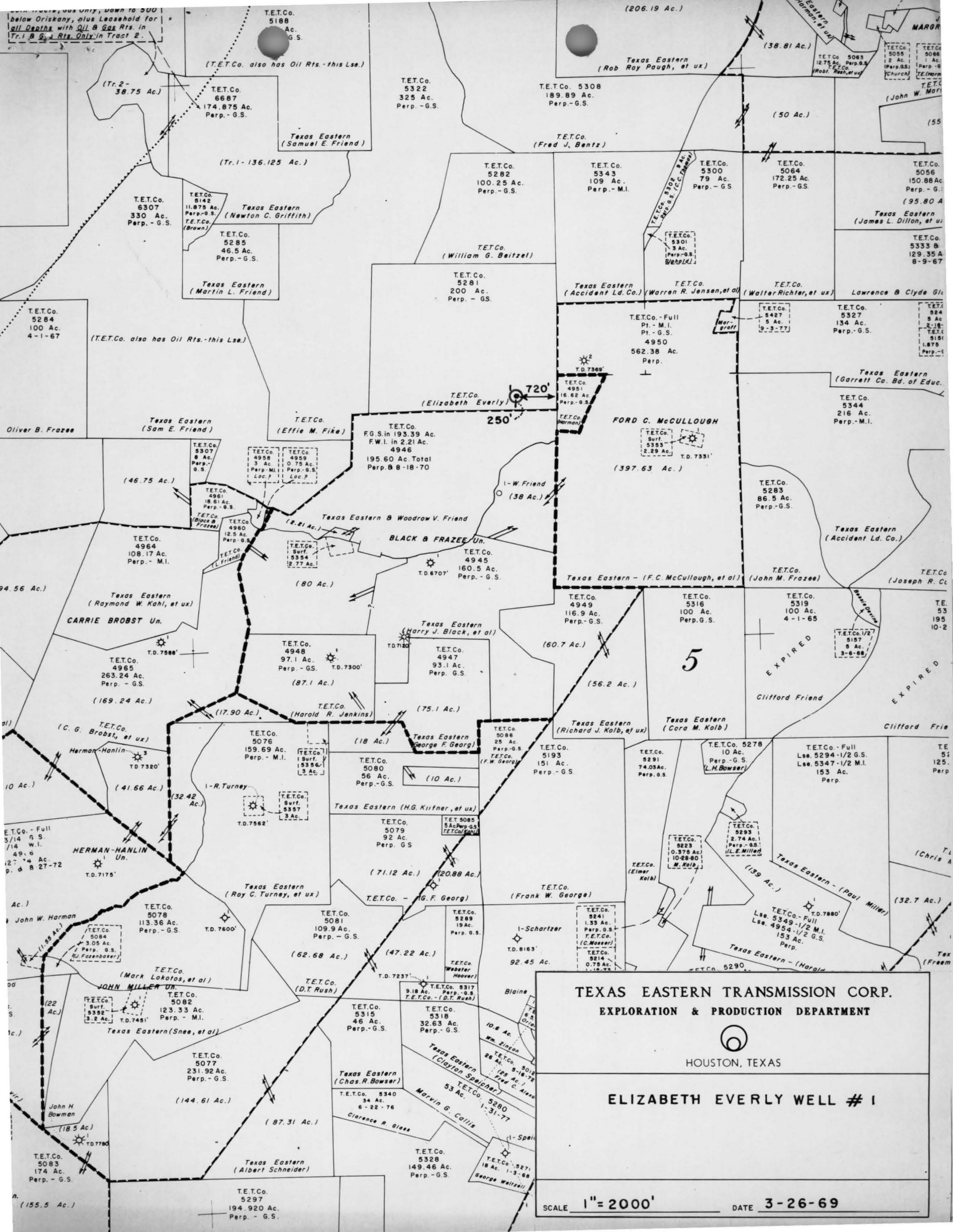

**TEXAS EASTERN TRANSMISSION CORP.**  
**EXPLORATION & PRODUCTION DEPARTMENT**

HOUSTON, TEXAS

**ELIZABETH EVERLY WELL # 1**

SCALE 1" = 2000'      DATE 3-26-69