

STATE OF MARYLAND
MARYLAND GEOLOGICAL SURVEY
 The Johns Hopkins University
 BALTIMORE, MARYLAND 21218

Permit Number 76Well Number 3Texas Eastern Transmission Corporation
Company _____County Garrett**COMPLETION REPORT**

(oil or gas well)

*This report must be submitted within 30 days after completion of the well*WELL DESCRIPTION - KIND OF WELL: Gas Storage

(Oil, Gas, Other)

NAME & WELL NO.	Size of Casting and Tubing	Used in Drilling	Left in Well	Packers: Type, Size and Depth
HELEN L. ENLOW, WELL NO. 3				
ELEVATION: _____ LEASE: <u>Helen L. Enlow</u>	13 3/8"	120'	120'	NONE
DRILLING COMMENCED: <u>7-1-66</u> DRILLING COMPLETED: <u>8-27-66</u>	9 5/8"	3,750'	3,750'	NONE
PRODUCTION: <u>Gas - 2,050 MCFD</u>	7"	7,414'	7,414'	NONE
	2 3/8"	7,514'	7,514'	NONE
RESERVOIR PRESSURE <u>2,280</u> psig <u>36</u> hrs.				
WELL TREATMENT: (Shooting, Acidizing, Fracturing, Etc.)				
Treated Open Hole 7,414'-7,631' (Oris.) with				PERFORATIONS AT: NONE
1,000 gals. 7 1/2% Acid Spearhead, 30,000 gals.				Open Hole:
water, 25,000# 20-40 Sand, and 5,000# 10-20 Sand.				7,414'-7,631'
	Note: All casing cemented to surface			
	CEMENTING DATA: (Size Pipe, Depth, No. Bags, Date)			
	7-3-66			
	13 3/8" 48# H-40 set at 120'. Cement w/150 sx Common Cement.			
	7-25-66			
	9 5/8" 36# J-55 set at 3,750'. Cement w/700 sx Diacel and 200 sx Common Cement.			
	8-13-66			
RESERVOIR PRESSURE AFTER TREATMENT: _____	7" 29# N-80 set at 7,414'. Cement w/150 sx Posmix and 65 sx Latex Cement - First Stage Cement thru Stage Collar at 6,821' w/1,100 sx Posmix and 50 sx Common Cement.			
2,315 psia after 120 HRS.				
RESULTS AFTER TREATMENT: _____				
3,600 MCFD at 80 psig.				
REMARKS:	GEOPHYSICAL LOGS (Type of Geophysical Logs Run on Well)			
Gas Storage Well	Gamma Ray - Neutron Log			
	Formation Density Log			
	Temperature Log			
	Directional Log			

GEOLOGICAL LOG

FORMATION	TOP	BOTTOM	GAS AT	OIL AT	WATER AT (Fresh or Salt Water)	REMARKS
Benson Sand	3,603	3,673	NONE	NONE	NONE	
Tully Lime	6,517	6,538	"	"	"	
Onondaga Lime	7,225	7,254	"	"	"	
Huntersville Chert	7,254	7,360	"	"	"	
Needmore Shale	7,360	7,408	"	"	"	
Oriskany Sand	7,408	7,628	7,568 7,411	"	"	
Helderberg Lime	7,628	7,631	NONE	"	"	
						Drlr. T. D. = 7,631'
						Logger T. D. = 7,626'
						Open Hole Completion -
						Oriskany Sand, 7,414'-7,631'

This completion report is accurate to the best of my knowledge.

Date September 28, 19 66

APPROVED J. D. Loden

By Chief Production Clerk

(Title)

COMPANY Texas Eastern Transmission Corp.

State of Maryland
MARYLAND GEOLOGICAL SURVEY
The Johns Hopkins University
Baltimore, Maryland 21218

Blanket Bond 11

76

APPLICATION FOR PERMIT TO DRILL OIL OR GAS WELL

(Applications must be submitted in triplicate)

HELEN L. ENLOW, WELL NO. 3

OWNER Texas Eastern Transmission Corporation
STREET or R.F.D. _____ P. O. Box 2521
POST OFFICE _____ Houston, Texas 77001

LOCATION OF WELL _____
COUNTY Garrett
NEAREST POST OFFICE Accident, Maryland
Distance from Post Office 11,131'
Direction from Post Office S 4° 59' E

PERMIT TO DRILL WELL

NOT TO BE FILLED IN BY APPLICANT

PERMIT NO. 76 - Seventy six

APPROXIMATE DEPTH OF WELL (feet) 7800

The permit is herewith granted subject to the conditions stipulated.

METHOD OF DRILLING Rotary

Kenneth D. Weaver
Director

DEEPEST GEOLOGIC FORMATION
WELL WILL BE DRILLED Oriskany

Date June 2, 1966

DISTANCE OF WELL LOCATION
TO NEAREST BUILDING (feet) No buildings
within 1500' of location

Special conditions that may apply:

NUMBER OF SHIFTS PER DAY Three

Gas Storage Well Only

LICENSED DRILLER IN CREW OF EACH SHIFT

Names of Drillers must be furnished
prior to drilling of well

NAME ADDRESS

To be furnished 7/5/66

These names may be supplied later but before drilling begins

The names and post office addresses of the owners of the tracts of land included on the plat or map accompanying the application are to be given below.

See Attached List

NOTE

A BOND FOR \$2,500 PAYABLE TO THE STATE OF MARYLAND MUST ACCOMPANY THE APPLICATION
THIS APPLICATION FORM MUST BE FILLED OUT WITH TYPEWRITER OR IN BLOCK LETTERS

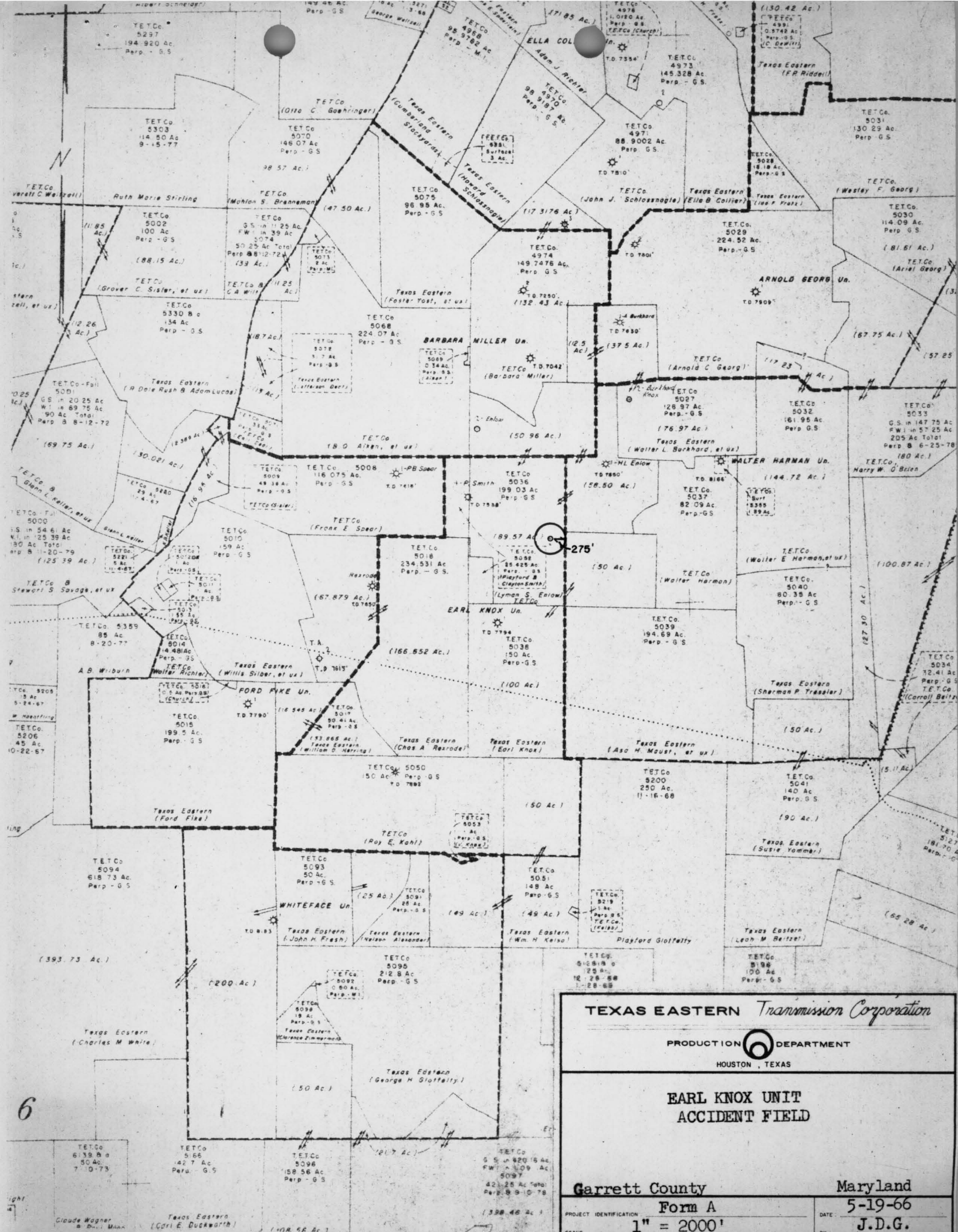

TEXAS EASTERN *Transmission Corporation*
 PRODUCTION DEPARTMENT
 HOUSTON, TEXAS

**EARL KNOX UNIT
 ACCIDENT FIELD**

Garrett County **Maryland**
 PROJECT IDENTIFICATION **Form A** DATE: **5-19-66**
 SCALE **1" = 2000'** BY: **J.D.G.**

6