

STATE OF MARYLAND
MARYLAND GEOLOGICAL SURVEY
 The Johns Hopkins University Texas Eastern Transmission Corporation
 BALTIMORE, MARYLAND 21218

Permit Number 75
 Well Number 4
 Company _____
 County Garrett

COMPLETION REPORT
 (oil or gas well)

This report must be submitted within 30 days after completion of the well

WELL DESCRIPTION - KIND OF WELL: Gas Storage
 (Oil, Gas, Other)

NAME & WELL NO.	Size of Casting and Tubing	Used in Drilling	Left in Well	Packers:
				Type, Size and Depth
BARBARA MILLER, WELL #4				
ELEVATION: <u>2,394'</u> G.L. LEASE: <u>Barbara Miller</u>	<u>13 3/8"</u>	<u>157'</u>	<u>157'</u>	<u>NONE</u>
DRILLING COMMENCED: <u>6-18-66</u> DRILLING COMPLETED: <u>7-25-66</u>	<u>9 5/8"</u>	<u>3,342'</u>	<u>3,342'</u>	<u>NONE</u>
PRODUCTION: <u>Gas</u>	<u>7"</u>	<u>7,277'</u>	<u>7,277'</u>	<u>NONE</u>
	<u>2 3/8"</u>	<u>7,360'</u>	<u>7,360'</u>	<u>NONE</u>
RESERVOIR PRESSURE <u>1,920</u> psig <u>12</u> hrs.				
WELL TREATMENT: (Shooting, Acidizing, Fracturing, Etc.)				
				PERFORATIONS AT:
1. <u>7,277'-7,415'</u> Open Hole Oriskany Zone				<u>NONE</u>
<u>with 2,000 gals. 5% HCL.</u>				<u>Open Hole</u>
2. <u>7,277'-7,415'</u> Open Hole Oriskany Zone				<u>7,277'-7,415'</u>
<u>with 35,000 gals. gelled water and 35,000 lbs. 20-40 sand.</u>				
RESERVOIR PRESSURE AFTER TREATMENT: _____				
<u>SMA</u> <u>SAME</u>				
RESULTS AFTER TREATMENT: <u>780</u> MCFD				
Natural - <u>381</u> MCFD after Acid - <u>1,740</u> MCFD after Fracture Treatment				
REMARKS:				
<u>Gas Storage Well</u>				

Note: All casing cemented back to the surface
 CEMENTING DATA: (Size Pipe, Depth, No. Bags, Date)
 6-19-66
 13 3/8" 48# H-40 set at 157', 150 sx Common Cement.
 6-26-66
 9 5/8" 36# J-55 set at 3,342', 552 sx 20% Diacel "D" Cement and 200 sx Common Cement.
 7-13-66
 7" 29# N-80 set at 7,277', 235 sx Posmix Cement and 45 sx Latex Cement - First Stage. 1,360 sx Posmix Cement and 50 sx Common Cement - Second Stage, 6,192'.

GEOPHYSICAL LOGS (Type of Geophysical Logs Run on Well)
 Formation - Density Log
 Temperature Log
 Gamma Ray - Neutron Log
 Continuous Directional Log
 Seismic Reference Log

GEOLOGICAL LOG

FORMATION	TOP	BOTTOM	GAS AT	OIL AT	WATER AT (Fresh or Salt Water)	REMARKS
Benson Sand	3,188	3,248	NONE	NONE	NONE	
Tully Lime	6,296	6,319	"	"	"	
Onondaga Lime	7,078	7,102	"	"	"	
Huntersville Chert	7,104	7,235	"	"	"	
Needmore Shale	7,235	7,277	"	"	"	
Oriskany Sand	7,277	7,412	7,392	"	"	
Helderberg Lime	7,412	-	NONE	"	"	T.D. 7,415' - Driller 7,419' - Logger Well Completed in Open Hole - Oriskany Sand.

This completion report is accurate to the best of my knowledge.

Date September 28, 19 66

APPROVED J. D. Fader

By Chief Production Clerk
 (Title)

COMPANY Texas Eastern Transmission Corp.

State of Maryland
MARYLAND GEOLOGICAL SURVEY
The Johns Hopkins University
Baltimore, Maryland 21218

Blanket Bond 11

75

APPLICATION FOR PERMIT TO DRILL OIL OR GAS WELL

(Applications must be submitted in triplicate)

BARBARA MILLER, WELL NO. 4

OWNER Texas Eastern Transmission Corporation

STREET or R.F.D. P. O. Box 2521

POST OFFICE Houston, Texas 77001

PERMIT TO DRILL WELL

NOT TO BE FILLED IN BY APPLICANT

PERMIT NO. 75 - Seventy five

The permit is herewith granted subject to the conditions stipulated.

Bennett N. Weaver
Director

Date June 2, 1966

Special conditions that may apply:

Gas Storage Well Only

Names of Drillers must be furnished prior to drilling of well

LOCATION OF WELL

COUNTY Garrett

NEAREST POST OFFICE Accident, Maryland

Distance from Post Office 7465'

Direction from Post Office S 1° 22' W

APPROXIMATE DEPTH OF WELL (feet) 7800

METHOD OF DRILLING Rotary

DEEPEST GEOLOGIC FORMATION WELL WILL BE DRILLED Oriskany

DISTANCE OF WELL LOCATION TO NEAREST BUILDING (feet) No buildings within 1500' of location

NUMBER OF SHIFTS PER DAY Three

LICENSED DRILLER IN CREW OF EACH SHIFT
NAME ADDRESS

To be furnished
M N Shoffner #4807 B Walker #4826
D Johnston #4813 C Parsons #4836

These names may be supplied later but before drilling begins

The names and post office addresses of the owners of the tracts of land included on the plat or map accompanying the application are to be given below.

See Attached List

NOTE

A BOND FOR \$2,500 PAYABLE TO THE STATE OF MARYLAND MUST ACCOMPANY THE APPLICATION THIS APPLICATION FORM MUST BE FILLED OUT WITH TYPEWRITER OR IN BLOCK LETTERS

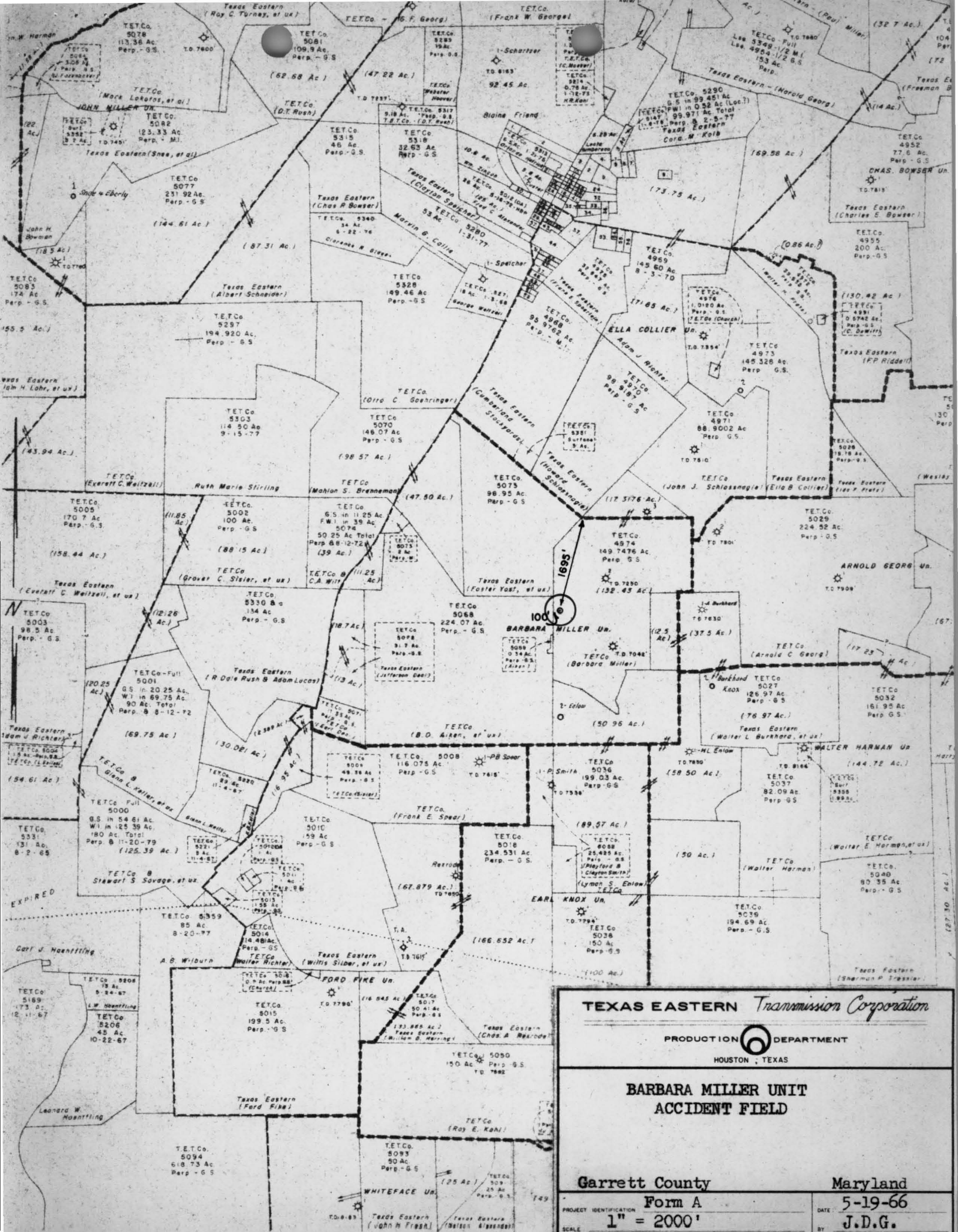

TEXAS EASTERN *Transmission Corporation*

PRODUCTION DEPARTMENT
HOUSTON, TEXAS

**BARBARA MILLER UNIT
ACCIDENT FIELD**

Garrett County Maryland

Form A

PROJECT IDENTIFICATION DATE: 5-19-66

1" = 2000'

SCALE BY: J.D.G.