

STATE OF MARYLAND
MARYLAND GEOLOGICAL SURVEY
 The Johns Hopkins University
 BALTIMORE, MARYLAND 21218

Permit Number 69
 Well Number 2
 Texas Eastern Transmission Corporation
 Company _____
 County Garrett

COMPLETION REPORT

(oil or gas well)

This report must be submitted within 30 days after completion of the well

WELL DESCRIPTION - KIND OF WELL: Dry

(Oil, Gas, Other)

NAME & WELL NO. <u>Charles A. Rexrode No. 2</u>	Size of Casting and Tubing	Used in Drilling	Left in Well	Packers: Type, Size and Depth
ELEVATION: <u>2521.5'</u> LEASE: <u>Charles A. Rexrode</u>	13 3/8"	133'	133'	NONE
DRILLING COMMENCED: <u>3-24-66</u> DRILLING COMPLETED: <u>4-23-66</u>	9 5/8"	3536'	3536'	NONE
PRODUCTION: <u>NONE</u>	7"	7460'	7460'	NONE
	2 3/8"	44'	44'	NONE

RESERVOIR PRESSURE - psig - hrs.

WELL TREATMENT: (Shooting, Acidizing, Fracturing, Etc.)

NONE

PERFORATIONS AT:
 NONE

CEMENTING DATA: (Size Pipe, Depth, No. Bags, Date)

13 3/8", 133', 150 sacks, 3-25-66; 9 5/8", 3536', 575 sacks 20% Diacel D + 150 sacks common, 4-10-66
7", 7460', cement in two stages

RESERVOIR PRESSURE AFTER TREATMENT:

1st Stage Around bottom, 480 sacks 50-50 Poz A + 60 sacks Latex, 4-18-66
2nd Stage Thru DV Tool at 5299' 690 sacks 50-50 Poz A + 100 sacks common, 4-18-66

RESULTS AFTER TREATMENT:

REMARKS:

No production. Well temporarily abandoned.

GEOPHYSICAL LOGS (Type of Geophysical Logs Run on Well)

Formation Density
 Gamma Ray - Neutron

MARYLAND GEOLOGICAL SURVEY

The Johns Hopkins University
BALTIMORE, MARYLAND 21218

GEOLOGICAL LOG

CHARLES A. REXRODE, WELL NO. 2

FORMATION	TOP	BOTTOM	GAS AT	OIL AT	WATER AT (Fresh or Salt Water)	REMARKS
Benson	3371	3434				
Tully	6602	6630				
Onondaga	7255	7267				
1st Huntersville Chert	7282	7318	NONE	NONE		
40' Fault	7318					
2nd Huntersville Chert	7323	7422				
Needmore	7422	7456				
Oriskany	7456	7592	NONE	NONE		
Helderberg	7592					

This completion report is accurate to the best of my knowledge.

Date May 20, 1966

APPROVED

By Chief Production Clerk

(Title)

COMPANY Texas Eastern Transmission Corp.

State of Maryland
MARYLAND GEOLOGICAL SURVEY
The Johns Hopkins University
Baltimore, Maryland 21218

Observation Well

APPLICATION FOR PERMIT TO DRILL OIL OR GAS WELL

(Applications must be submitted in triplicate)

CHARLES A. REXRODE, WELL NO. 2

OWNER Texas Eastern Transmission Corporation

LOCATION OF WELL

STREET or R.F.D. P. O. Box 2521

COUNTY Garrett

POST OFFICE Houston, Texas 77001

NEAREST POST OFFICE Accident, Maryland

Distance from Post Office 13,554'

Direction from Post Office S 13° 07' 25" W

PERMIT TO DRILL WELL

NOT TO BE FILLED IN BY APPLICANT

PERMIT NO. 69 - (Sixty-nine)

APPROXIMATE DEPTH OF WELL (feet) 7415'

METHOD OF DRILLING Rotary

The permit is herewith granted subject to the conditions stipulated.

DEEPEST GEOLOGIC FORMATION
WELL WILL BE DRILLED Oriskany

Kenneth N. Weaver
Director

DISTANCE OF WELL LOCATION
TO NEAREST BUILDING (feet) 720

Date March 9, 1966

NUMBER OF SHIFTS PER DAY Three

Special conditions that may apply:

Gas Storage Well Only

LICENSED DRILLER IN CREW OF EACH SHIFT
NAME ADDRESS

Names of Drillers must be furnished
prior to drilling of well

To be furnished

King #4812 Weekley #4814

Johnston #4813

These names may be supplied later but before drilling begins

The names and post office addresses of the owners of the tracts of land included on the plat or map accompanying the application are to be given below.

See attached list

NOTE

A BOND FOR \$2,500 PAYABLE TO THE STATE OF MARYLAND MUST ACCOMPANY THE APPLICATION
THIS APPLICATION FORM MUST BE FILLED OUT WITH TYPEWRITER OR IN BLOCK LETTERS

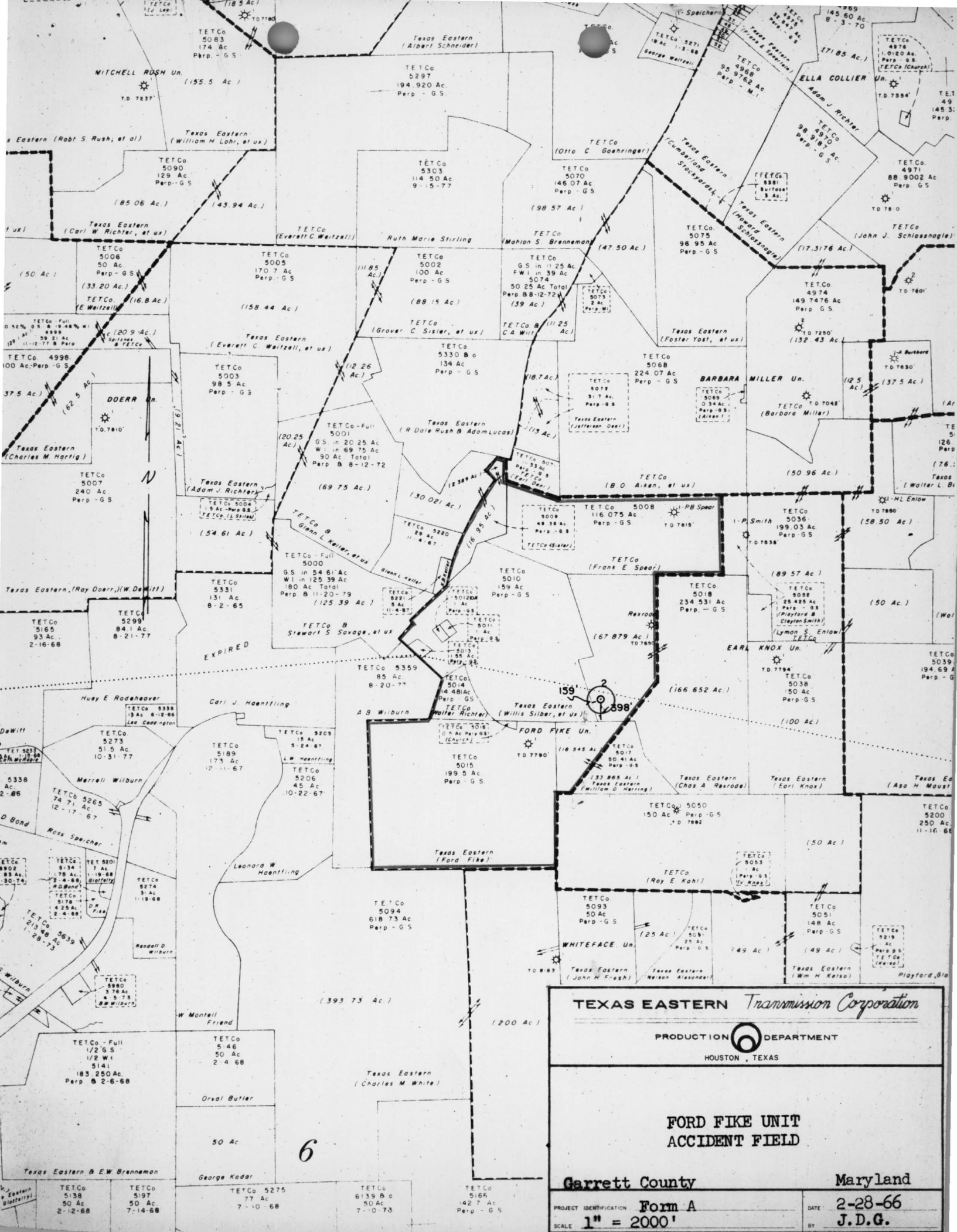

TEXAS EASTERN *Transmission Corporation*

PRODUCTION DEPARTMENT
HOUSTON, TEXAS

**FORD FIKE UNIT
ACCIDENT FIELD**

Garrett County **Maryland**

PROJECT IDENTIFICATION **Form A** DATE **2-28-66**

SCALE **1" = 2000'** BY **J.D.G.**

6