

STATE OF MARYLAND  
**MARYLAND GEOLOGICAL SURVEY**

The Johns Hopkins University  
 BALTIMORE, MARYLAND 21218 Texas Eastern Transmission Corporation  
 Company

Permit Number 68

Well Number 1

**COMPLETION REPORT**

(oil or gas well)

County Garrett

*This report must be submitted within 30 days after completion of the well*

WELL DESCRIPTION - KIND OF WELL: Gas  
 (Oil, Gas, Other)

NAME & WELL NO.	Size of Casting and Tubing	Used in Drilling	Left in Well	Packers: Type, Size and Depth
Snee & Eberly, Well No. 1 Snee & Eberly	13 3/8"	75	75	NONE
ELEVATION: <u>2445'</u> LEASE: <u>Eberly</u>	9 5/8"	2007	2007	NONE
DRILLING COMMENCED: <u>5/12/66</u> DRILLING COMPLETED: <u>6/19/66</u>	7"	7296	7296	NONE
PRODUCTION: <u>Gas</u>				

RESERVOIR PRESSURE 1506 psig 48 hrs.

WELL TREATMENT: (Shooting, Acidizing, Fracturing, Etc.)  
 Treated with 3000 gals. 7 1/2% HCl atomized with 384,000 SCF of nitrogen. Displaced with nitrogen.

PERFORATIONS AT:  
 None - Open Hole  
 7296' to 7430'

CEMENTING DATA: (Size Pipe, Depth, No. Bags, Date)

13 3/8", 75', 75 sacks, 5/13/66.  
 9 5/8", 2007', 475 sacks, 5/20/66.  
 7", 7296', 1st Stage, 430 sacks around bottom, 2nd Stage, 1400 sacks thru DV Tool @ 6191', 6/13/66.

RESERVOIR PRESSURE AFTER TREATMENT:

RESULTS AFTER TREATMENT: Tested 5910  
 MCF/Day. Tested 5870 MCF/Day before.

REMARKS:

GEOPHYSICAL LOGS (Type of Geophysical Logs Run on Well)  
 Formation Density  
 Gamma Ray - Neutron

MARYLAND GEOLOGICAL SURVEY

The Johns Hopkins University  
BALTIMORE, MARYLAND 21218

SNEE & EBERLY, WELL NO. 1

GEOLOGICAL LOG

FORMATION	TOP	BOTTOM	GAS AT	OIL AT	WATER AT (Fresh or Salt Water)	REMARKS
Tully	6254	6285				
Onondaga	7038	7055				
1st Huntersville Chert	7058	7131				
75' Fault	7131					
2nd Huntersville Chert	7134	7259				
Needmore Shale	7259	7504	?			
Oriskany	7326		7331'			5800 MCF/Day

This completion report is accurate to the best of my knowledge.

Date July 25, 1966

APPROVED J. D. Sade

By Chief Production Clerk  
(Title)

COMPANY Texas Eastern Transmission Corp.

State of Maryland  
MARYLAND GEOLOGICAL SURVEY  
The Johns Hopkins University  
Baltimore, Maryland 21218

APPLICATION FOR PERMIT TO DRILL OIL OR GAS WELL

(Applications must be submitted in triplicate)

SNEE & EBERLY, WELL NO. 1

OWNER Texas Eastern Transmission Corporation

LOCATION OF WELL

STREET or R.F.D. P. O. Box 2521

COUNTY Garrett

POST OFFICE Houston, Texas 77001

NEAREST POST OFFICE Accident, Maryland

Distance from Post Office 8,605'

Direction from Post Office N 88° 41' 02" W

PERMIT TO DRILL WELL

NOT TO BE FILLED IN BY APPLICANT

PERMIT NO. 68 - (Sixty-eight)

APPROXIMATE DEPTH OF WELL (feet) 7450'

The permit is herewith granted subject to the conditions stipulated.

METHOD OF DRILLING Rotary

DEEPEST GEOLOGIC FORMATION  
WELL WILL BE DRILLED Oriskany

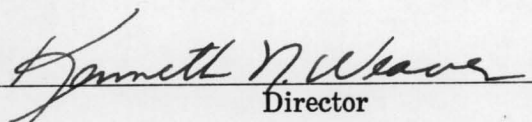
  
Director

DISTANCE OF WELL LOCATION  
TO NEAREST BUILDING (feet) No buildings  
within 1500' of location

Date March 9, 1966

NUMBER OF SHIFTS PER DAY Three

Special conditions that may apply:

Gas Storage Well Only

LICENSED DRILLER IN CREW OF EACH SHIFT  
NAME ADDRESS

Names of Drillers must be furnished  
prior to drilling of well

~~To be~~ furnished 5/16/66

# 4838 - Bryant      # 4840 - Hunter

# 4839 - Hames      # 4841 - McClead

These names may be supplied later but before drilling begins

The names and post office addresses of the owners of the tracts of land included on the plat or map accompanying the application are to be given below.

See attached list

**NOTE**

A BOND FOR \$2,500 PAYABLE TO THE STATE OF MARYLAND MUST ACCOMPANY THE APPLICATION  
THIS APPLICATION FORM MUST BE FILLED OUT WITH TYPEWRITER OR IN BLOCK LETTERS

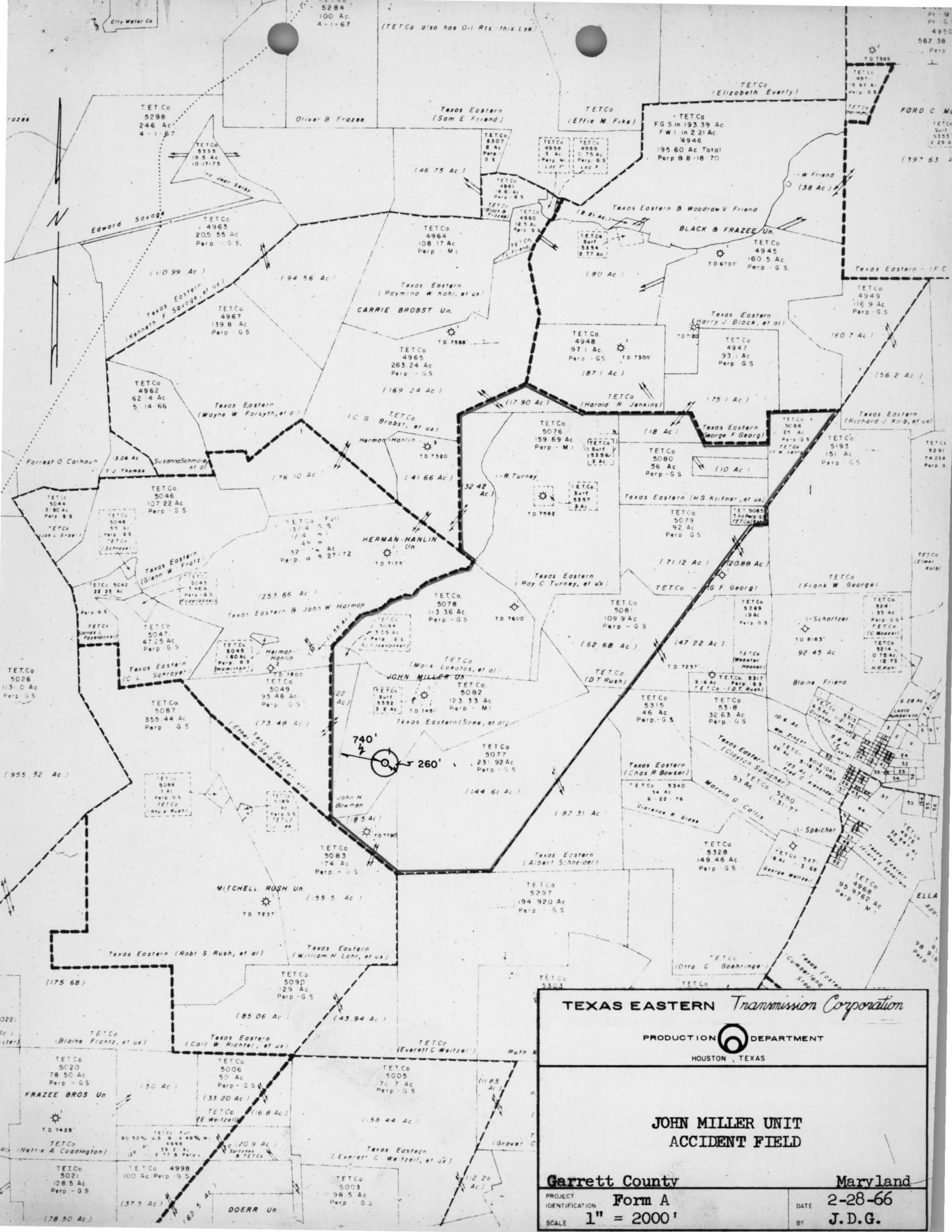

**TEXAS EASTERN** *Transmission Corporation*  
 PRODUCTION DEPARTMENT  
 HOUSTON, TEXAS

**JOHN MILLER UNIT  
 ACCIDENT FIELD**

**Garrett County** **Maryland**  
 PROJECT IDENTIFICATION **Form A** DATE **2-28-66**  
 SCALE **1" = 2000'** BY **J.D.G.**