

STATE OF MARYLAND
MARYLAND GEOLOGICAL SURVEY
 The Johns Hopkins University
 BALTIMORE, MARYLAND 21218

Permit Number 64

Well Number 4

Texas Eastern Transmission Corporation
 Company _____

COMPLETION REPORT

County Garrett

(oil or gas well)

This report must be submitted within 30 days after completion of the well

WELL DESCRIPTION - KIND OF WELL: Shut-In for study

(Oil, Gas, Other)

NAME & WELL NO. <u>Herman & Hanlin, Well No. 4</u>	Size of Casting and Tubing	Used in Drilling	Left in Well	Packers: Type, Size and Depth
ELEVATION: _____ LEASE: <u>Herman & Hanlin</u>	13 3/8"	125'	125'	NONE
DRILLING COMMENCED: <u>4/6/66</u> DRILLING COMPLETED: <u>6/9/66</u>	9 5/8"	2495'	2495'	NONE
PRODUCTION: <u>None</u>	7"	7362'	7362'	NONE
	4 1/2"		7102 to 7565'	NONE
RESERVOIR PRESSURE <u>Not measured</u> psig _____ hrs.	2 3/8"		45'	NONE
WELL TREATMENT: (Shooting, Acidizing, Fracturing, Etc.)				
<u>Not treated</u>				PERFORATIONS AT: Oriskany 7457-64 and 7482-88

CEMENTING DATA: (Size Pipe, Depth, No. Bags, Date)

13 3/8", 125', 150 sacks, 4/8/66.
 9 5/8", 2495', 500 sacks, 4/19/66.
 7", 7365', 1st Stage 210 sacks around bottom.
 2nd Stage 1190 sacks thru DV Tool @ 6395,
 5/17/66.
 4 1/2" Liner, 7102 to 7565', 80 sacks 6/5/66

RESERVOIR PRESSURE AFTER TREATMENT: _____

-

-

RESULTS AFTER TREATMENT: _____

REMARKS:

SEE PAGE TWO

GEOPHYSICAL LOGS (Type of Geophysical Logs Run on Well)

FORMATION DENSITY
 GAMMA RAY - NEUTRON

64

Blanket bond
m 28 15 82

State of Maryland
MARYLAND GEOLOGICAL SURVEY
 The Johns Hopkins University
 Baltimore, Maryland 21218

AMENDED

APPLICATION FOR PERMIT TO DRILL OIL OR GAS WELL

AMENDED

(Applications must be submitted in triplicate)

HERMAN & HANLIN, WELL NO. 4

OWNER Texas Eastern Transmission Corporation

STREET or R.F.D. P. O. Box 2521

POST OFFICE Houston, Texas 77001

PERMIT TO DRILL WELL

NOT TO BE FILLED IN BY APPLICANT

PERMIT NO. 64 (Sixty-four)

The permit is herewith granted subject to the conditions stipulated.

Kenneth N. Weas

 Director

Date April 14, 1966

Special conditions that may apply:

Gas Storage Well Only

LOCATION OF WELL _____

COUNTY Garrett

NEAREST POST OFFICE Accident, Maryland

Distance from Post Office 8,407'

Direction from Post Office N 60° 11' 18" W

APPROXIMATE DEPTH OF WELL (feet) 7425

METHOD OF DRILLING Rotary

DEEPEST GEOLOGIC FORMATION
 WELL WILL BE DRILLED Oriskany

DISTANCE OF WELL LOCATION
 TO NEAREST BUILDING (feet) _____

No buildings within 1500'

NUMBER OF SHIFTS PER DAY Three

LICENSED DRILLER IN CREW OF EACH SHIFT

NAME

ADDRESS

To be furnished - _____

#4832 J.K. Eastwood #4834 M. W. O'Dell

#4833 John Hyatt, Jr. #4835 L. J. Rishel

These names may be supplied later but before drilling begins

The names and post office addresses of the owners of the tracts of land included on the plat or map accompanying the application are to be given below.

See Attached List

NOTE

A BOND FOR \$2,500 PAYABLE TO THE STATE OF MARYLAND MUST ACCOMPANY THE APPLICATION
 THIS APPLICATION FORM MUST BE FILLED OUT WITH TYPEWRITER OR IN BLOCK LETTERS

State of Maryland
MARYLAND GEOLOGICAL SURVEY
 The Johns Hopkins University
 Baltimore, Maryland 21218

APPLICATION FOR PERMIT TO DRILL OIL OR GAS WELL

(Applications must be submitted in triplicate)

HERMAN & HANLIN, WELL NO. 4

OWNER Texas Eastern Transmission Corporation

STREET or R.F.D. P. O. Box 2521

POST OFFICE Houston, Texas 77001

LOCATION OF WELL

COUNTY Garrett

NEAREST POST OFFICE Accident, Maryland

Distance from Post Office 8,573'

Direction from Post Office N 59° 26' 59" W

PERMIT TO DRILL WELL

NOT TO BE FILLED IN BY APPLICANT

PERMIT NO. 64 (Sixty-four)

The permit is herewith granted subject to the conditions stipulated.

Kenneth D. Weaver
 Director

Date February 28, 1966

Special conditions that may apply:

"Gas Storage Well Only"

Names of Drillers must be furnished prior to drilling of well.

APPROXIMATE DEPTH OF WELL (feet) 7425

METHOD OF DRILLING Rotary

DEEPEST GEOLOGIC FORMATION WELL WILL BE DRILLED Oriskany

DISTANCE OF WELL LOCATION TO NEAREST BUILDING (feet) No buildings within 1500'

NUMBER OF SHIFTS PER DAY Three

LICENSED DRILLER IN CREW OF EACH SHIFT

NAME	ADDRESS
<u>To be furnished</u>	

These names may be supplied later but before drilling begins

The names and post office addresses of the owners of the tracts of land included on the plat or map accompanying the application are to be given below.

See attached list

NOTE

A BOND FOR \$2,500 PAYABLE TO THE STATE OF MARYLAND MUST ACCOMPANY THE APPLICATION THIS APPLICATION FORM MUST BE FILLED OUT WITH TYPEWRITER OR IN BLOCK LETTERS

State of Maryland
MARYLAND GEOLOGICAL SURVEY
 The Johns Hopkins University
 Baltimore, Maryland 21218

JH

APPLICATION FOR PERMIT TO DRILL OIL OR GAS WELL

(Applications must be submitted in triplicate)

HERMAN & HANLIN, WELL NO. 4

OWNER Texas Eastern Transmission Corporation

STREET or R.F.D. P. O. Box 2521

POST OFFICE Houston, Texas 77001

LOCATION OF WELL

COUNTY Garrett

NEAREST POST OFFICE Accident, Maryland

Distance from Post Office 8,573'

Direction from Post Office N 59° 26' 59" W

PERMIT TO DRILL WELL

NOT TO BE FILLED IN BY APPLICANT

PERMIT NO. 64 (Sixty-four)

The permit is herewith granted subject to the conditions stipulated.

Dennett M. Weaver
 Director

Date February 28, 1966

Special conditions that may apply:

"Gas Storage Well Only"

Names of Drillers must be furnished prior to drilling of well.

APPROXIMATE DEPTH OF WELL (feet) 7425

METHOD OF DRILLING Rotary

DEEPEST GEOLOGIC FORMATION WELL WILL BE DRILLED Oriskany

DISTANCE OF WELL LOCATION TO NEAREST BUILDING (feet)

No buildings within 1500'

NUMBER OF SHIFTS PER DAY Three

LICENSED DRILLER IN CREW OF EACH SHIFT

NAME	ADDRESS
<u>To be furnished</u>	

These names may be supplied later but before drilling begins

The names and post office addresses of the owners of the tracts of land included on the plat or map accompanying the application are to be given below.

See attached list

NOTE

A BOND FOR \$2,500 PAYABLE TO THE STATE OF MARYLAND MUST ACCOMPANY THE APPLICATION THIS APPLICATION FORM MUST BE FILLED OUT WITH TYPEWRITER OR IN BLOCK LETTERS

WJG FAB 3/3/66
LE JJB
HEM JBN
JW

State of Maryland
MARYLAND GEOLOGICAL SURVEY
The Johns Hopkins University
Baltimore, Maryland 21218

APPLICATION FOR PERMIT TO DRILL OIL OR GAS WELL

(Applications must be submitted in triplicate)

HERMAN & HANLIN, WELL NO. 4

OWNER Texas Eastern Transmission Corporation

STREET or R.F.D. P. O. Box 2521

POST OFFICE Houston, Texas 77001

LOCATION OF WELL

COUNTY Garrett

NEAREST POST OFFICE Accident, Maryland

Distance from Post Office 8,573'

Direction from Post Office N 59° 26' 59" W

PERMIT TO DRILL WELL

NOT TO BE FILLED IN BY APPLICANT

PERMIT NO. 64 (Sixty-four)

APPROXIMATE DEPTH OF WELL (feet) 7425

The permit is herewith granted subject to the conditions stipulated.

METHOD OF DRILLING Rotary

DEEPEST GEOLOGIC FORMATION WELL WILL BE DRILLED Oriskany

Kenneth M. Meade
Director

DISTANCE OF WELL LOCATION TO NEAREST BUILDING (feet) _____

No buildings within 1500'

Date February 28, 1966

Special conditions that may apply:

"Gas Storage Well Only"

NUMBER OF SHIFTS PER DAY Three

LICENSED DRILLER IN CREW OF EACH SHIFT
NAME ADDRESS

Names of Drillers must be furnished prior to drilling of well.

To be furnished _____

These names may be supplied later but before drilling begins

The names and post office addresses of the owners of the tracts of land included on the plat or map accompanying the application are to be given below.

See attached list

NOTE

A BOND FOR \$2,500 PAYABLE TO THE STATE OF MARYLAND MUST ACCOMPANY THE APPLICATION THIS APPLICATION FORM MUST BE FILLED OUT WITH TYPEWRITER OR IN BLOCK LETTERS

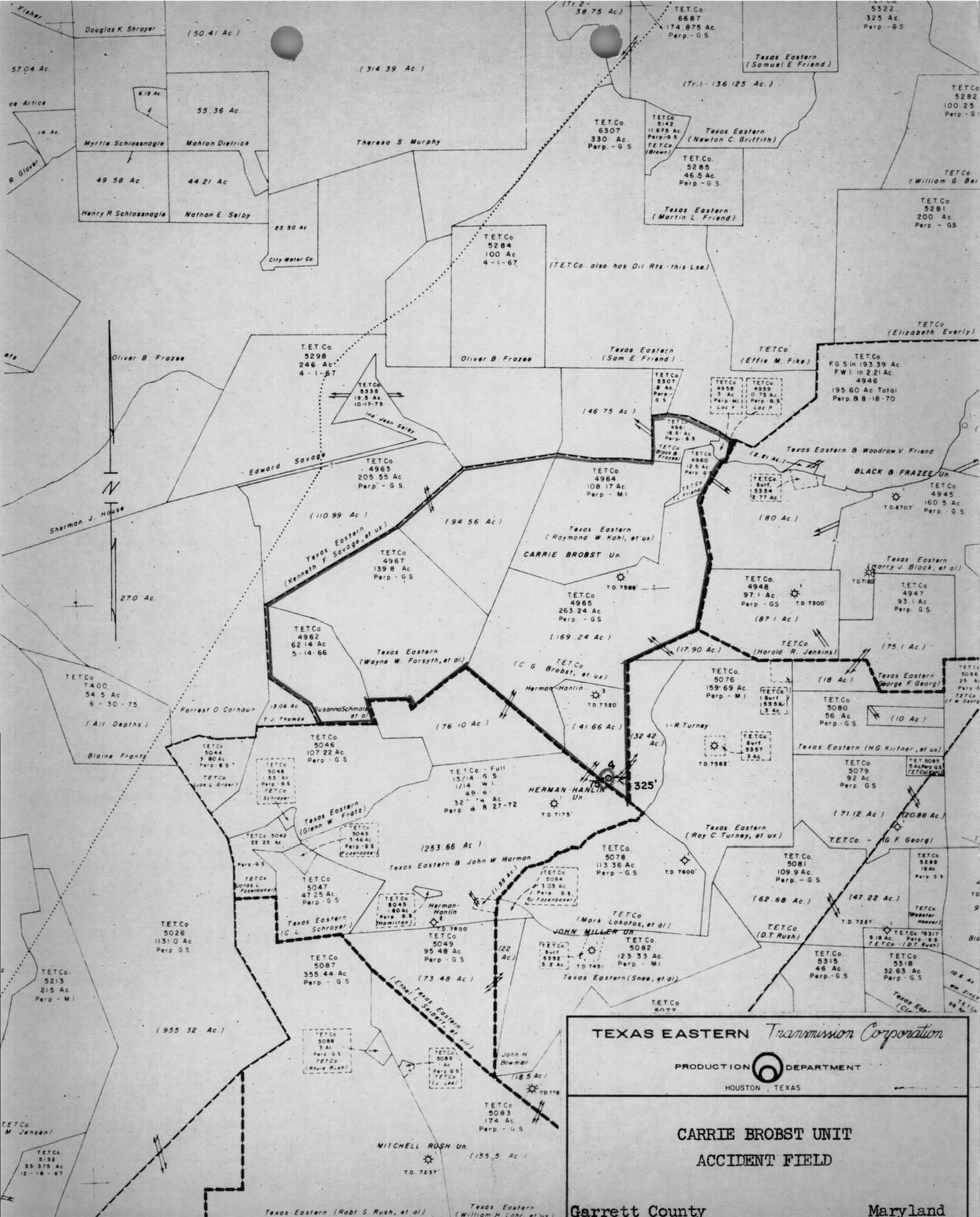

TEXAS EASTERN *Transmission Corporation*

PRODUCTION DEPARTMENT
HOUSTON, TEXAS

**CARRIE BROBST UNIT
ACCIDENT FIELD**

Garrett County **Maryland**

PROJECT IDENTIFICATION	Form A
SCALE	1" = 2000'
DATE	2-18-66
BY	J.D.G.