

STATE OF MARYLAND
DEPARTMENT OF GEOLOGY, MINES AND WATER RESOURCES Page 1 of 2

The Johns Hopkins University
BALTIMORE 18, MARYLAND

WELL COMPLETION REPORT PERIOD B. SPEAR, WELL NO. 1

This report must be submitted within 30 days after completion of the well

WELL DESCRIPTION

WELL LOG

State the kind of formations penetrated, their depth, their thickness, and if water-bearing

CASING AND SCREEN RECORD

State the kind and size of casing, liner, shoe, screen, and other accessories (if no casing used, give diameter of well)

Permit Number..... 52
Name of Owner Texas Eastern
Transmission Corporation

FEET

from.....to.....

DIAM.

(inches)

FEET

from.....to.....

PUMPING TEST

Hours Pumped
Type of Pump Used NONE
Pumping Rate -
Gallons per Minute.....

WATER LEVEL

Distance from land surface to water:
Before Pumping..... 250 Ft.
When Pumping..... Ft.

APPEARANCE OF WATER

Clear
Cloudy
Taste Fresh
NONE
Odor

Height of Casing Above Land Surface NONE Ft.

PUMP INSTALLED

Type
Capacity
Gallons per Minute.....
Gallons per Hour.....
Pump Column Length..... Ft.

REMARKS

Well Was Completed
Date September 16, 1965

Well Driller
J. D. Gaden
Signature

CONDUCTOR

48#, H-40, ST & C, cemented w/150 sx. cement circulated to surface.

SURFACE

36#, J-55, ST & C, cemented w/616 sx. 20% Diacel D + 200 sx. common. Cement circulated to surface.

PRODUCTION

29#, N-80, LT & C, cemented around bottom with 30 sx. 20% Diacel D cement, 55 sx. common, and 35 sx. common w/latex. Cemented 2nd stage thru DU tool at 6855' with 554 sx. Diacel D + 100 sx. common cement. Cement circulated to surface.

LINER

4 1/2" 7112-7612
13.5#, N-80, LT & C, cemented with 45 sx. common cement + 30 sx. common w/latex.

TUBING

2 3/8" 0-7475
2 3/8" OD, 4.7#, J-55,

7615

13 3/8

0-132

0-133

133-250

250-3442

3442-7217

7217-7376

7376-7515

7515-7615

9 5/8

0-3433

7"

0-7376

3300

7178

7209

7329

7365

7496

7250-56

7270-80

7374-94

7433-42

7470-80

2 3/8"

0-7475

TOTAL DEPTH

DRILLING INFORMATION

Drilled 17 1/2" hole w/air
Drilled 12 1/4" hole w/air
Drilled 12 1/4" hole w/foam
Drilled 8 3/4" hole w/air
Drilled 8 3/4" hole w/gas
Drilled 6 1/8" hole w/gas
Drilled 6" hole w/gas

GEOLOGICAL INFORMATION

Tops
Benson Sandstone
Onondaga Limestone
Huntersville Chert
Needmore Shale
Oriskany Sandstone
Helderberg Limestone

PERFORATIONS

Huntersville Chert (6 shots per foot)
Oriskany Sandstone (4 shots per foot)

STATE OF MARYLAND
DEPARTMENT OF GEOLOGY, MINES AND WATER RESOURCES Page 2 of 2

The Johns Hopkins University
BALTIMORE 18, MARYLAND

WELL COMPLETION REPORT PERIOD B. SPEAR, WELL NO. 1

This report must be submitted within 30 days after completion of the well

WELL DESCRIPTION				Permit Number..... 52
WELL LOG State the kind of formations penetrated, their depth, their thickness, and if water-bearing		CASING AND SCREEN RECORD State the kind and size of casing, liner, shoe, screen, and other accessories (if no casing used, give diameter of well)		Name of Owner
	FEET from.....to.....		DIAM. (inches)	FEET from.....to.....
<u>TREATMENTS</u>				
Oriskany Sandstone	7470-80 7433-42			
<p><u>No. 1</u> treated w/4000 gals. Halliburton 10% MCA. <u>No. 2</u> treated with 2000 gals. 10% MCA. <u>No. 3</u> treated with 10,000 gals. gelled 5% acid and 30,000 gals. gelled fresh water with 25,000 lbs. of 20-40 mesh sand. <u>No. 4</u> treated with 5000 gals. 15% retarded acid, 10,000 gals. 10% retarded acid and 40,000 gals. 5% acid. Tested 171 MCF/day before treatment, 232 MCF/day after.</p> <p>Oriskany Sandstone 7374-94 Treated with 5000 gals. 15% retarded gelled acid, 10,000 gals. of 10% retarded acid and 40,000 gals. of 5% gelled acid with 50,000# of 20-40 mesh sand. No production before treatment. Tested 96 MCF/day after treatment.</p> <p>Huntersville Chert 7250-56 7270-80 <u>No. 1</u> treated with 1000 gals. 15% mud acid. <u>No. 2</u> treated with 2000 gals. mud acid and 50,000 gals. 5% mud acid with 50,000# of 20-40 mesh sand. Tested 16 MCF/day before treatment, 780 MCF/day after.</p> <p><u>FINAL TEST</u> All zones flowing thru casing 1750 MCF/day.</p>				
PUMPING TEST				
Hours Pumped				
Type of Pump Used.....				
Pumping Rate				
Gallons per Minute.....				
WATER LEVEL				
Distance from land surface to water:				
Before Pumping.....Ft.				
When Pumping.....Ft.				
APPEARANCE OF WATER				
Clear				
Cloudy				
Taste				
Odor				
Height of Casing Above Land SurfaceFt.				
PUMP INSTALLED				
Type				
Capacity				
Gallons per Minute.....				
Gallons per Hour.....				
Pump Column Length.....Ft.				
REMARKS				
.....				
.....				
.....				
.....				
.....				
.....				
.....				
.....				
Well Was Completed				
Date				
Well Driller.....				
.....				
Signature				

State of Maryland
MARYLAND GEOLOGICAL SURVEY.
The Johns Hopkins University
Baltimore, Maryland 21218

APPLICATION FOR PERMIT TO DRILL OIL OR GAS WELL
(Applications must be submitted in triplicate)

PERIOD B. SPEAR, WELL #1

OWNER TEXAS EASTERN TRANSMISSION CORP. LOCATION OF WELL

STREET or R.F.D. P. O. BOX 2521

COUNTY GARRETT

POST OFFICE HOUSTON, TEXAS 77001

NEAREST POST OFFICE ACCIDENT, MARYLAND

Distance from Post Office 10,112'

PERMIT TO DRILL WELL

Direction from Post Office
S 9° 32' 53" W

NOT TO BE FILLED IN BY APPLICANT

APPROXIMATE DEPTH OF WELL (feet) 7800

PERMIT NO. 52 (Fifty-two)

METHOD OF DRILLING ROTARY

The permit is herewith granted subject to the conditions stipulated.

DEEPEST GEOLOGIC FORMATION
WELL WILL BE DRILLED ORISKANY

Bennett N. Weaver
Director

DISTANCE OF WELL LOCATION
TO NEAREST BUILDING (feet) 2200

Date May 28, 1965

NUMBER OF SHIFTS PER DAY 3

Special conditions that may apply:

"Gas storage well only"

LICENSED DRILLER IN CREW OF EACH SHIFT
NAME ADDRESS

**Names of Drillers must be
furnished prior to drilling**

TO BE FURNISHED (7/27/65)

These names may be supplied later but
before drilling begins

The names and post office addresses of the owners of the tracts of land included on the plat or map accompanying the application are to be given below.

SEE ATTACHED LIST

NOTE

A BOND FOR \$2,500 PAYABLE TO THE STATE OF MARYLAND MUST ACCOMPANY THE APPLICATION
THIS APPLICATION FORM MUST BE FILLED OUT WITH TYPEWRITER OR IN BLOCK LETTERS

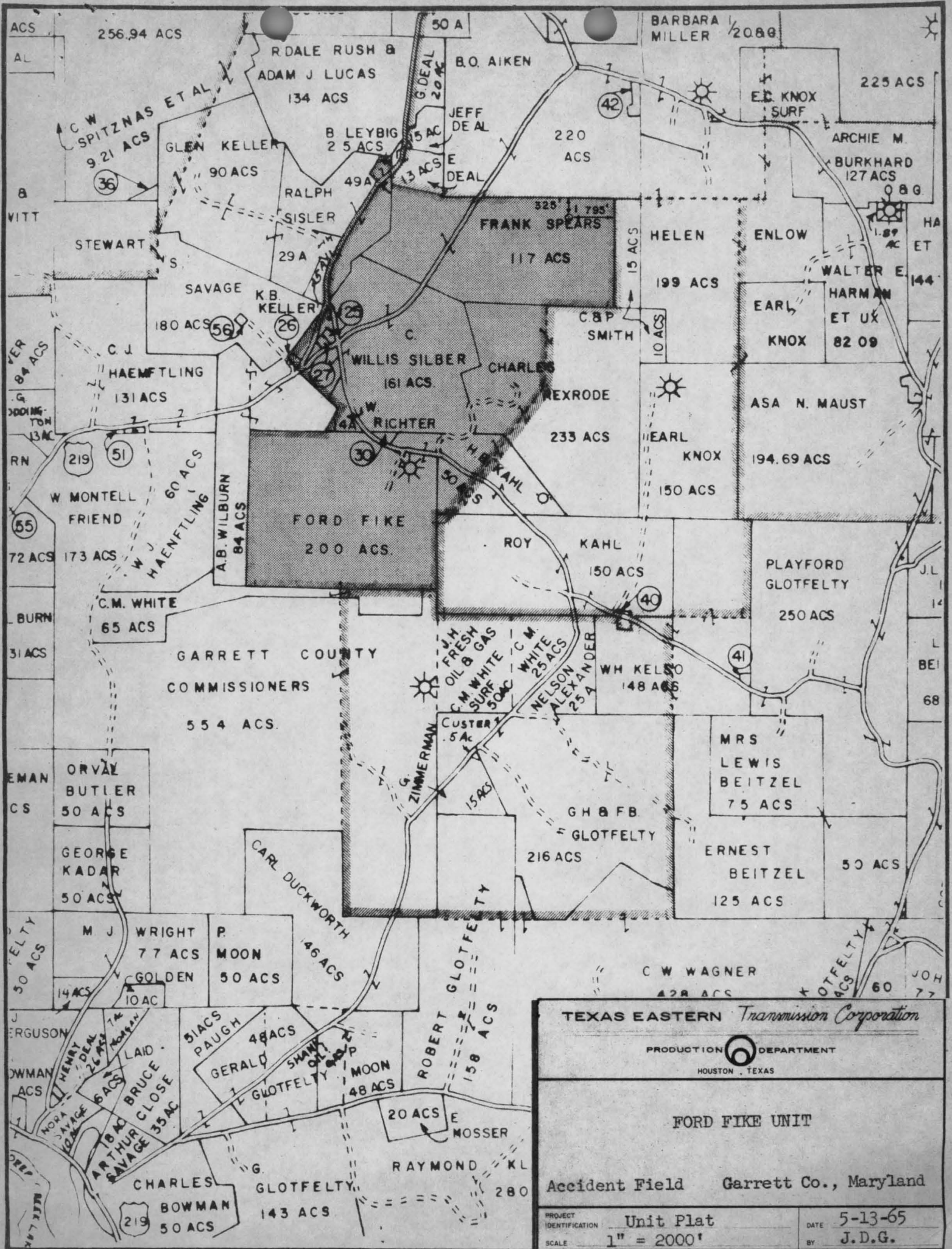

TEXAS EASTERN *Transmission Corporation*
 PRODUCTION DEPARTMENT
 HOUSTON, TEXAS

FORD FIKE UNIT
 Accident Field Garrett Co., Maryland
 PROJECT IDENTIFICATION Unit Plat
 SCALE 1" = 2000'
 DATE 5-13-65
 BY J.D.G.