

STATE OF MARYLAND  
DEPARTMENT OF GEOLOGY, MINES AND WATER RESOURCES

The Johns Hopkins University  
BALTIMORE 18, MARYLAND

WELL COMPLETION REPORT HERMAN AND HANLIN, WELL NO. 3

This report must be submitted within 30 days after completion of the well

Elevations:

Ground Level: 2,245  
Kelly Bushing: 2,261

WELL DESCRIPTION

Permit Number.....48.....

Name of Owner Texas Eastern  
Transmission Corporation

WELL LOG

State the kind of formations penetrated, their depth, their thickness, and if water-bearing

CASING AND SCREEN RECORD

State the kind and size of casing, liner, shoe, screen, and other accessories (if no casing used, give diameter of well)

PUMPING TEST

Hours Pumped .....

Type of Pump Used.....

Pumping Rate  
Gallons per Minute.....

WATER LEVEL

Distance from land surface to water:

Before Pumping.....Ft.

When Pumping.....Ft.

APPEARANCE OF WATER

Clear .....

Cloudy .....

Taste .....

Odor .....

Height of Casing Above Land

Surface .....Ft.

PUMP INSTALLED

Type .....

Capacity

Gallons per Minute.....

Gallons per Hour.....

Pump Column Length.....Ft.

REMARKS

Well Was Completed  
Date ..... January 27, 1965

Well Driller  
*J. D. Gaden*  
J. D. Gaden Signature

	FEET		DIAM. (inches)	FEET	
	from.....to.....			from.....to.....	
Total Depth:	7,323				
Drilling Information:					
Drilled 17 1/2" Hole-Air	0-111'				
Drilled 12 1/4" Hole-Foam	111'-3310'				
Drilled 8 3/4" Hole-Air	3,310'to 4,960'				
Drilled 8 3/4" Hole-Mud	4,960'to 7,133'				
Drilled 6 1/8" Hole-Air	7,133'to 7,323				
Geological Information:					
Top Onondaga Limestone	6,975'				
Top Huntersville Chert	6,999'				
Top Needmore Shale	7,104'				
Top Oriskany Sandstone	7,134'				
Top Helderberg Limestone	7,278'				
Completion Information:					
Open Hole Completion					
Oriskany Sandstone and Helderberg Limestone From 7,130' to 7,323'					
Test Before Treatment:					
807 MCFD gas at 133 psia					
		Conductor: 48# H-40 ST& C Set at 102' Cemented to surface with 90 sx common cement with 2% CaCl.	13 3/8"	0-102'	
		Surface: 36# J-55 ST&C Set at 3299 Baker Float Shoe at 3297' Baker Float Collar at 3273' Baker Centralizers-4 cemented to surface with 435 sx Diacel cement followed by 200 sx Common Cement.	9 5/8"	0-3,299'	
		Production: 29# N-80 LT&C Set at 7,130' Baker Float Shoe at 7,128' Baker Float Collar at 7,090' Baker Stage Collar at 6,052'. Cemented around shoe with 75 sx Diacel Cement followed by 50 sx Common Cement. Cemented thru Stage Collar at 6052' back to surface with 590 sx Diacel Cement followed by 50 sx Common Cement	7"	0-7,130	

STATE OF MARYLAND PAGE 2 OF 2  
 DEPARTMENT OF GEOLOGY, MINES AND WATER RESOURCES

The Johns Hopkins University  
 BALTIMORE 18, MARYLAND

**WELL COMPLETION REPORT** HERMAN AND HANLIN, WELL NO. 3

*This report must be submitted within 30 days after completion of the well*

**WELL DESCRIPTION**

**WELL LOG**

State the kind of formations penetrated, their depth, their thickness, and if water-bearing

**CASING AND SCREEN RECORD**

State the kind and size of casing, liner, shoe, screen, and other accessories (if no casing used, give diameter of well)

Permit Number.....48.....

Name of Owner Texas Eastern  
 Transmission Corporation

**F E E T**

from.....to.....

**D I A M.**

(inches)

**F E E T**

from.....to.....

**PUMPING TEST**

Hours Pumped .....

Type of Pump Used.....

Pumping Rate  
 Gallons per Minute.....

**WATER LEVEL**

Distance from land surface to water:

Before Pumping.....Ft.

When Pumping.....Ft.

**APPEARANCE OF WATER**

Clear .....

Cloudy .....

Taste .....

Odor .....

Height of Casing Above Land  
 Surface .....Ft.

**PUMP INSTALLED**

Type .....

Capacity

Gallons per Minute.....

Gallons per Hour.....

Pump Column Length.....Ft.

**REMARKS**

Well Was Completed

Date .....

Well Driller.....

*J. D. Fede*  
 Signature

Treatment:

Acidized open hole  
 from 7,130' to 7,323'  
 with 12,000 gallons  
 12% HCL with nitrogen.

Test After Treatment:

1,595 MCFD Gas at 120 psia

Tubing:

4.7# N-80 EUE  
 with Bull Plug  
 on bottom, 6#.  
 Perforated joint  
 above Bull Plug,  
 and PSI Landing  
 Nipple set at  
 7,145'. Well tubed  
 to 7,184'.

2 3/8" 0-7,184'



State of Maryland  
MARYLAND GEOLOGICAL SURVEY  
The Johns Hopkins University  
Baltimore 18, Maryland

APPLICATION FOR PERMIT TO DRILL OIL OR GAS WELL  
(Applications must be submitted in triplicate)

Herman & Hanlin, Well No. 3

OWNER <u>Texas Eastern Transmission Corp.</u>	LOCATION OF WELL
STREET or R.F.D. <u>P. O. Box 2521</u>	COUNTY <u>Garrett</u>
POST OFFICE <u>Houston, Texas 77001</u>	NEAREST POST OFFICE <u>Accident, Maryland</u>
	Distance from Post Office <u>9,628 feet</u>
	Direction from Post Office <u>N 52° 33' 07" W</u>
PERMIT TO DRILL WELL	APPROXIMATE DEPTH OF WELL (feet) <u>7,800</u>
NOT TO BE FILLED IN BY APPLICANT	METHOD OF DRILLING <u>Rotary</u>
PERMIT NO. <u>48 (Forty eight)</u>	DEEPEST GEOLOGIC FORMATION
The permit is herewith granted subject to the conditions stipulated.	WELL WILL BE DRILLED <u>Oriskany</u>
<i>Ernest D. Weaver</i> Director	DISTANCE OF WELL LOCATION TO NEAREST BUILDING (feet) <u>No buildings within 2,000 feet.</u>
Date <u>November 4, 1964</u>	NUMBER OF SHIFTS PER DAY <u>Three</u>
Special conditions that may apply: Names of drillers must be furnished prior to drilling and well is to be used for <u>storage only</u>	LICENSED DRILLER IN CREW OF EACH SHIFT
	NAME ADDRESS
	To be furnished prior to drilling.
	<u>furnished 1/21/65</u>
	These names may be supplied later but before drilling begins

The names and post office addresses of the owners of the tracts of land included on the plat or map accompanying the application are to be given below.

See attached list.

NOTE

A BOND FOR \$2,500 PAYABLE TO THE STATE OF MARYLAND MUST ACCOMPANY THE APPLICATION THIS APPLICATION FORM MUST BE FILLED OUT WITH TYPEWRITER OR IN BLOCK LETTERS

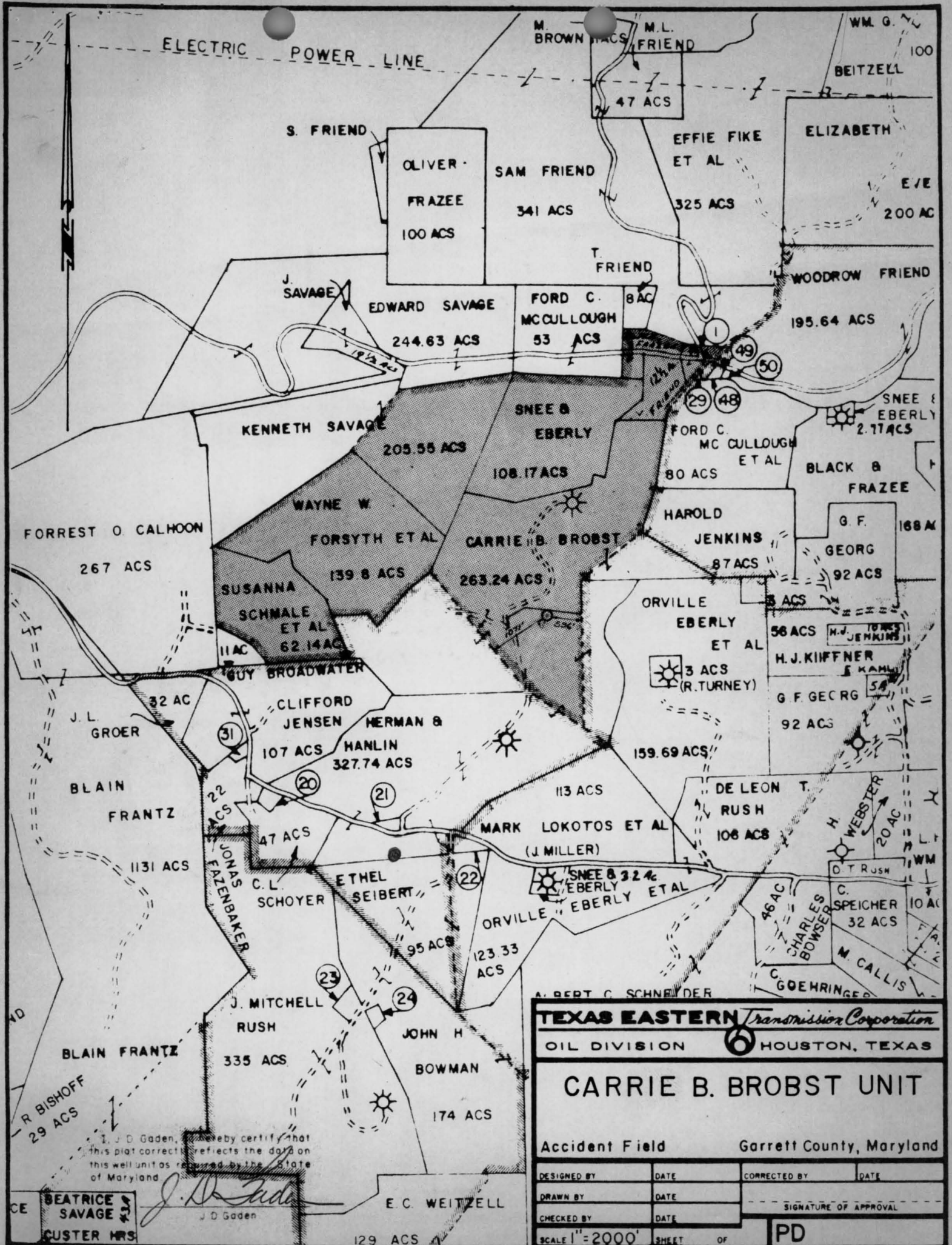

I, J. D. Gaden, hereby certify that this plat correctly reflects the data on this well unit as required by the State of Maryland.

*J. D. Gaden*  
J. D. Gaden

**TEXAS EASTERN** *Transmission Corporation*  
OIL DIVISION **HOUSTON, TEXAS**

**CARRIE B. BROBST UNIT**

Accident Field Garrett County, Maryland

DESIGNED BY	DATE	CORRECTED BY	DATE
DRAWN BY	DATE	SIGNATURE OF APPROVAL	
CHECKED BY	DATE	PD	
SCALE 1" = 2000'	SHEET OF		