

STATE OF MARYLAND PAGE 1 of 2 PAGES
 DEPARTMENT OF GEOLOGY, MINES AND WATER RESOURCES

The Johns Hopkins University
 BALTIMORE 18, MARYLAND

WELL COMPLETION REPORT HELEN L. ENLOW, WELL NO. 1

This report must be submitted within 30 days after completion of the well

ELEVATIONS:

Ground Level: 2,572'
 Kelly Bushing: 2,588'

WELL DESCRIPTION

Permit Number..... 44
 Name of Owner Texas Eastern
 Transmission Corporation

WELL LOG

State the kind of formations penetrated, their depth, their thickness, and if water-bearing

CASING AND SCREEN RECORD

State the kind and size of casing, liner, shoe, screen, and other accessories (if no casing used, give diameter of well)

WELL LOG		CASING AND SCREEN RECORD		PUMPING TEST	
State the kind of formations penetrated, their depth, their thickness, and if water-bearing		State the kind and size of casing, liner, shoe, screen, and other accessories (if no casing used, give diameter of well)		Hours Pumped None	
	FEET from.....to.....		DIAM. (inches)	FEET from.....to.....	Type of Pump Used.....
TOTAL DEPTH:	7,850'	CONDUCTOR:	13 3/8"	0 - 95	Pumping Rate Gallons per Minute.....
DRILLING INFORMATION:		48# H-40 ST & C set at 95' Cemented with 100 sx. common cement with 2% CaCl.			WATER LEVEL
Drilled 17 1/2" Hole - Air	0 to 95'				Distance from land surface to water:
Drilled 12 1/4" Hole - Air	95' to 190'				Before Pumping.....None Ft.
Drilled 12 1/4" Hole - Foam	190' to 3,945'	SURFACE:	9 5/8"	0-3,928'	When Pumping.....Ft.
Drilled 8 3/4" Hole - Air	3,945' to 7,352'	36# J-55 ST & C set at 3,928' Cemented to sur- face with 650 sx. Diacel cement and 200 sx. common cement.			APPEARANCE OF WATER
(Junked Hole-Plug Back-Side tracked hole.)					Clear 190 Ft.
Drilled 8 3/4" Hole - Mud	4,915' to 7,480'	Baker Float Shoe @3,928'			Cloudy
Drilled 6 1/8" Hole - Gas	7,480' to 7,850'	Baker Float Collar @3,894'			Taste Fresh
					Odor None
GEOLOGICAL INFORMATION:		PRODUCTION:	7"	0-7,480'	Height of Casing Above Land Surface None Ft.
Top - Benson Sandstone	3,577'	29# N-80 LT & C set at 7,480' Cemented first stage 7,480' to 6,970' with 50 sx. Diacel cement and 45 sx. common cement with Latex. Cemented second stage from stage collar at 6,970' to surface with 677 sx. Diacel cement and 50 sx. common cement.			PUMP INSTALLED
Top - Onondaga Limestone	7,313'				Type None
Top - Huntersville Chert	7,345'				Capacity
Top - Needmore Shale	7,477'				Gallons per Minute.....
Top - Oriskany Sandstone	7,528'				Gallons per Hour.....
Top - Helderberg Limestone	7,787'				Pump Column Length.....Ft.
COMPLETION INFORMATION:		Halliburton Float Shoe @7,480'			REMARKS
Liner Completion Perforations - 4 shots/foot		Halliburton Float Collar @7,444'		
Lower Oriskany	7,725' to 33'	Halliburton Stage Collar @6,970'		
Upper Oriskany	7,529' to 40'			
Natural Flow - Open Hole 7,480' to 7,850'				
103 MCFD				
					Well Was Completed Date July 24, 1965
					Well Driller..... J. D. Gaden Signature

The Johns Hopkins University
 BALTIMORE 18, MARYLAND

WELL COMPLETION REPORT HELEN L. ENLOW, WELL NO. 1

This report must be submitted within 30 days after completion of the well

WELL DESCRIPTION

Permit Number..... 44

Name of Owner

WELL LOG

State the kind of formations penetrated, their depth, their thickness, and if water-bearing

CASING AND SCREEN RECORD

State the kind and size of casing, liner, shoe, screen, and other accessories (if no casing used, give diameter of well)

TREATMENTS:

Lower Oriskany: Perfs.

Test Flow: 0 MCFD
 Acidized with 4000 Gals.
 10% mud acid.

Test Flow: 5 MCFD
 Acidized with 27,000 Gals.
 5% gelled acid with 1/4#/Gal. sand.

Test Flow: 204 MCFD
 Upper Oriskany: Perfs.

Test Flow: 0 MCFD
 Acidized with 2400 Gals.
 10% mud acid.
 Test Flow: 10 MCFD
 Acidized with 30,000 Gals.
 5% gelled acid with 1/4#/Gal. sand.
 Test Flow: 20.25 MCFD
 Acidized well with 20,000 Gals.
 15% acid, 30,000 Gals.
 5% acid and overflushed with 15,000 Gals. salt water
 Test Flow: ± 25 MCFD

Final Test:

Both Intervals Combined:

300 MCFD

F E E T
 from.....to.....

7,725' to 33'

7,529' to 40'

LINER:

13.5# N-80 LT & C set 629' of liner cemented with 65 sx. common cement and 55 sx. common Latex cement.
 Brown Set Shoe @7,848'
 Brown Landing Collar @7,815'

TUBING:

4.7# J-55 EUE well tubed to 7,749'. Bull Plug on bottom, 6' perforated sub from 7,749' to 43' and P.S.I. landing nipple at 7,712'.

D I A M.
 (inches) from.....to.....

4 1/2" 7,218' to 7,847'

2 3/8" 0-7,749'

PUMPING TEST

Hours Pumped

Type of Pump Used.....

Pumping Rate
 Gallons per Minute.....

WATER LEVEL

Distance from land surface to water:

Before Pumping.....Ft.

When Pumping.....Ft.

APPEARANCE OF WATER

Clear

Cloudy

Taste

Odor

Height of Casing Above Land SurfaceFt.

PUMP INSTALLED

Type

Capacity

Gallons per Minute.....

Gallons per Hour.....

Pump Column Length.....Ft.

REMARKS

Well Was Completed

Date

Well Driller.....

Signature

State of Maryland
MARYLAND GEOLOGICAL SURVEY
The Johns Hopkins University
Baltimore, Maryland 21218

APPLICATION FOR PERMIT TO DRILL OIL OR GAS WELL
(Applications must be submitted in triplicate)

Amended location _____, Helen Enlow, Well No. 1 _____

OWNER Texas Eastern Transmission Corporation LOCATION OF WELL _____

STREET or R.F.D. P. O. Box 2521 COUNTY Garrett

POST OFFICE Houston, Texas 77001 NEAREST POST OFFICE Accident, Maryland

Distance from Post Office 9,934'

Direction from Post Office _____

PERMIT TO DRILL WELL

S 1° 09' 16" E

NOT TO BE FILLED IN BY APPLICANT

APPROXIMATE DEPTH OF WELL (feet) 7800

PERMIT NO. 44 METHOD OF DRILLING Rotary

The permit is herewith granted subject to DEEPEST GEOLOGIC FORMATION
the conditions stipulated. WELL WILL BE DRILLED Oriskany

Bennett N. Weaver
Director

DISTANCE OF WELL LOCATION
TO NEAREST BUILDING (feet) 1000'

Date March 31, 1965 NUMBER OF SHIFTS PER DAY 3

Special conditions that may apply:
"Gas storage well only"
Names of Drillers must be
furnished prior to drilling

LICENSED DRILLER IN CREW OF EACH SHIFT
NAME ADDRESS

To be furnished _____

These names may be supplied later but
before drilling begins

The names and post office addresses of the owners of the tracts of land included on
the plat or map accompanying the application are to be given below.

See attached list

NOTE

A BOND FOR \$2,500 PAYABLE TO THE STATE OF MARYLAND MUST ACCOMPANY THE APPLICATION
THIS APPLICATION FORM MUST BE FILLED OUT WITH TYPEWRITER OR IN BLOCK LETTERS

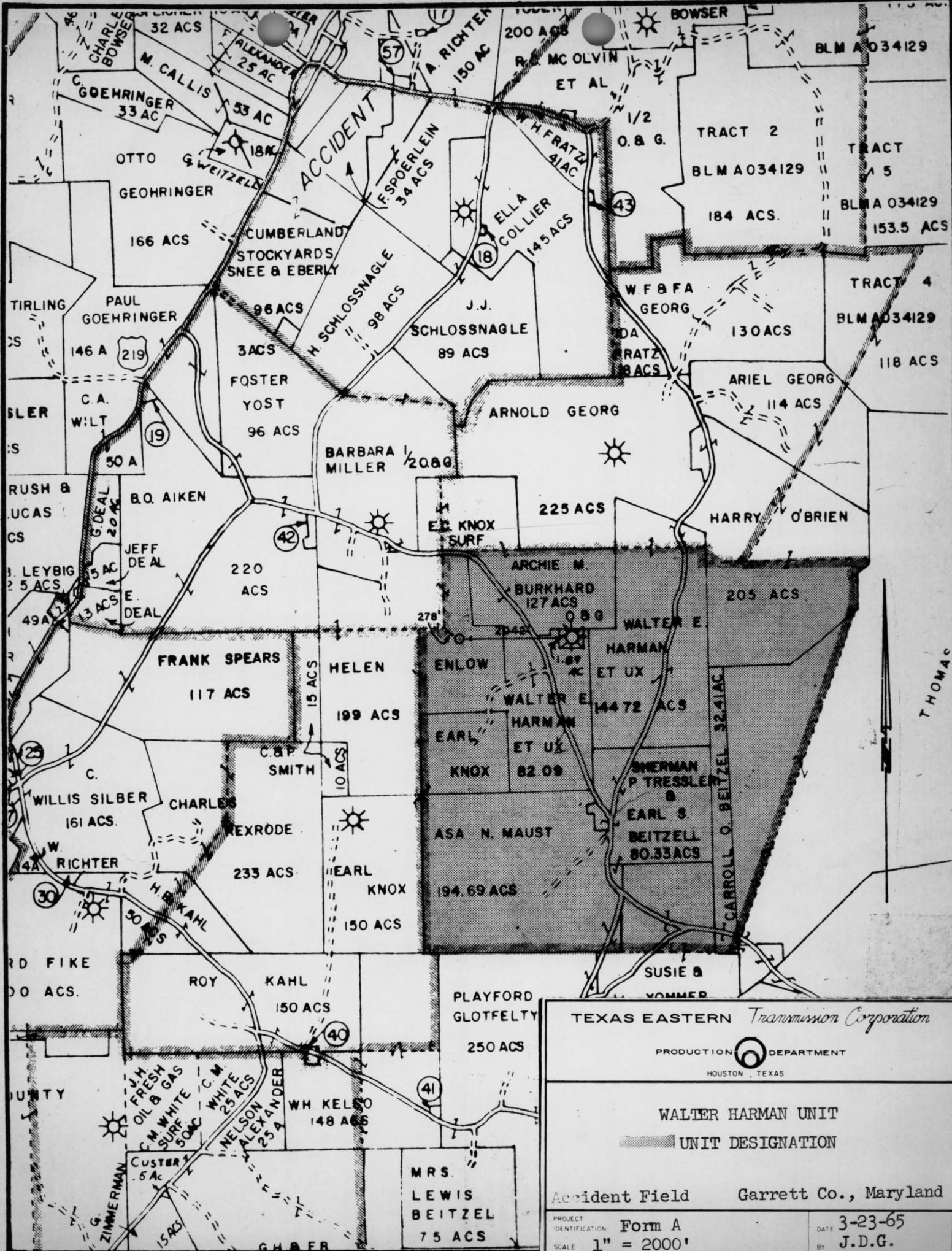

TEXAS EASTERN *Transmission Corporation*

PRODUCTION DEPARTMENT
HOUSTON, TEXAS

WALTER HARMAN UNIT
UNIT DESIGNATION

Accident Field Garrett Co., Maryland

PROJECT IDENTIFICATION Form A
SCALE 1" = 2000'

DATE 3-23-65
BY J.D.G.

State of Maryland
 DEPARTMENT OF GEOLOGY, MINES AND WATER RESOURCES
 The Johns Hopkins University
 Baltimore 18, Maryland

APPLICATION FOR PERMIT TO DRILL OIL OR GAS WELL
 (Applications must be submitted in triplicate)

Helen Enlow, Well No. 1

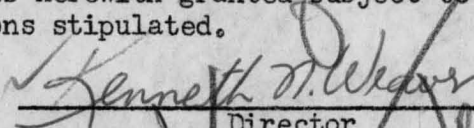
OWNER <u>Texas Eastern Transmission Corp.</u> STREET or R.F.D. <u>P. O. Box 2521</u> POST OFFICE <u>Houston, Texas 77001</u> PERMIT TO DRILL WELL NOT TO BE FILLED IN BY APPLICANT PERMIT NO. <u>44 (Forty four)</u> The permit is herewith granted subject to the conditions stipulated. <div style="text-align: center;">  _____ Director </div> Date <u>July 31, 1964</u> Special conditions that may apply: Names of drillers must be furnished prior to drilling	LOCATION OF WELL COUNTY <u>Garrett</u> NEAREST POST OFFICE <u>Accident, Maryland</u> Distance from Post Office <u>10,741 feet</u> Direction from Post Office <u>S 1° 27 min. 03 sec. E</u> APPROXIMATE DEPTH OF WELL (feet) <u>7,800</u> METHOD OF DRILLING <u>Rotary (Air)</u> DEEPEST GEOLOGIC FORMATION WELL WILL BE DRILLED <u>Oriskany</u> DISTANCE OF WELL LOCATION TO NEAREST BUILDING (feet) <u>1,400</u> NUMBER OF SHIFTS PER DAY <u>3</u> LICENSED DRILLER IN CREW OF EACH SHIFT <table style="width: 100%; border-collapse: collapse;"> <thead> <tr> <th style="text-align: center; border-bottom: 1px solid black;">NAME</th> <th style="text-align: center; border-bottom: 1px solid black;">ADDRESS</th> </tr> </thead> <tbody> <tr> <td style="border-bottom: 1px solid black;">To be furnished.</td> <td style="border-bottom: 1px solid black;"></td> </tr> <tr> <td style="border-bottom: 1px solid black;"></td> <td style="border-bottom: 1px solid black;"></td> </tr> </tbody> </table> These names may be supplied later but before drilling begins	NAME	ADDRESS	To be furnished.			
NAME	ADDRESS						
To be furnished.							

The names and post office addresses of the owners of the tracts of land included on the plat or map accompanying the application are to be given below.

See attached list.

NOTE

A BOND FOR \$2,500 PAYABLE TO THE STATE OF MARYLAND MUST ACCOMPANY THE APPLICATION THIS APPLICATION FORM MUST BE FILLED OUT WITH TYPEWRITER OR IN BLOCK LETTERS