

MAIL TO:

*waiting*

STATE OF DELAWARE

*KT 13-66*

http://www.dnrec.state.de.us/

WATER SUPPLY SECTION  
DIVISION OF WATER RESOURCES  
89 KINGS HIGHWAY  
DOVER, DELAWARE 19901

DEPARTMENT OF NATURAL RESOURCES  
AND ENVIRONMENTAL CONTROL

APPLICATION MUST BE SUBMITTED  
AND PERMIT RECEIVED BEFORE  
DRILLING IS STARTED.

APPLICATION FOR A PERMIT  
TO CONSTRUCT A WELL

- OFFICIAL USE ONLY -

PHONE: 302-739-3665  
FAX: 302-739-7764

**FAXED**

PAGE # 7 OF 4 PAGES  
PERMIT NO: 203283

ILLEGIBLE OR INCOMPLETE FORMS WILL BE RETURNED

PLEASE TYPE OR PRINT - USE BLUE OR BLACK INK ONLY

Property Owner: Chester W. Downes  
Address: Rd. 3 Box 256  
City: Millsboro State: DE Zip: 19955  
Telephone Number: \_\_\_\_\_  
Licensed Preparer/WC: B+B Mechanical, Inc  
Lic. #: 600 Date of Application: 8-6-04  
Estimated Construction Date: 8-15-04

PURPOSE:  Test  Permanent  Temporary for Well Construction

USE:  Domestic  Irrigation  
 Industrial  Agricultural  
 Public  Heat Pump Supply  
 Miscellaneous Public  Heat Pump Recharge  
 Other (Specify): \_\_\_\_\_  Closed Loop Heat Pump

Is this a replacement well?  NO  YES (Reason): \_\_\_\_\_

Is public water available?  NO  YES (Utility): \_\_\_\_\_

On public sewage?  YES  OR Septic system permit #: 2026545

PROPOSED WELL CONSTRUCTION:

	Inner Casing	Outer Casing
Approximate total depth:	<u>60'</u> ft.	ft.
Casing top (above grade):	<u>8"</u> in.	in.
Casing bottom (below grade):	<u>50'</u> ft.	ft.
Casing diameter:	<u>4"</u>	
Casing material:	<u>PVC</u>	

Proposed screen setting: 50' top ft. TO: 60' bottom ft. Material: PVC

Type of Grout: Best From: 0 top To: 40' bottom

Gravel pack:  NO  YES From: 50' top To: 60' bottom

Maximum capacity: 15 (GPM) Max. Daily Withdrawal: 360 (GPD)

Will the operation of this well by itself or in combination with any other well(s), owned or operated by the permittee, withdraw greater than 50,000 gallons in any 24 hr. period?  NO  YES

I HEREBY AFFIRM THE INFORMATION I HAVE SUBMITTED IS ACCURATE AND CORRECT.

Signature: [Signature] Date: 8-6-04  
Licenses/Preparer/Water Well Contractor

Signature: [Signature] Date: 8/6/04  
Property Owner

Please release the contractor's copy of the permit and the well tag to the water well contractor noted on this application:

YES  NO

LOCATION MAP - ROAD MAP

County:  New Castle  Kent  Sussex

Subdivision: \_\_\_\_\_

Lot #: \_\_\_\_\_ ADC Map Grid: \_\_\_\_\_

Tax Map/Parcel #: 3-33-11-37.01

Name of Nearest Town: Gumbro

Distance to Nearest Town: 2 miles

DIRECTION OF WELL FROM TOWN (CIRCLE DIRECTION)

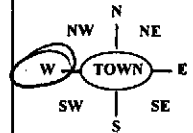

Draw a sketch below showing location of well in relation to at least two county or state roads, give distance from well site to nearest road junction and SHOW A NORTH ARROW.

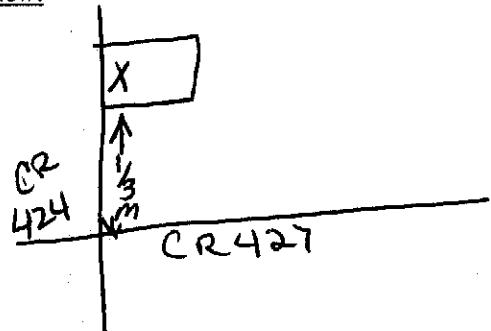

Site Plan - Include lot size and dimensions, distances from well to house, property lines, nearest road, and all nearby septic systems (include suitable plot plan if available).

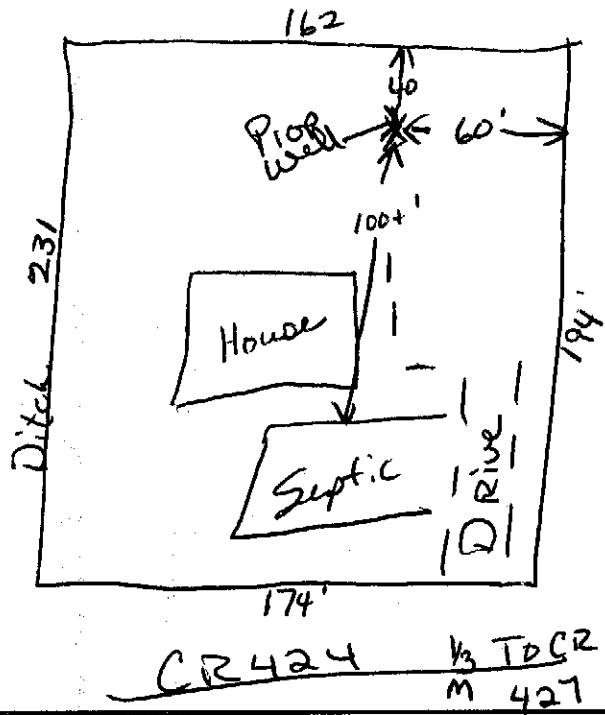

PERMIT #: 2032832D

- FOR OFFICIAL USE ONLY - DO NOT WRITE BELOW THIS LINE -

Received By: [Signature] Modified Grid: 148-056 DRBC:  YES  NO X-Coord: 203953  
Amount: 35 Drainage Basin: 313 H<sub>2</sub>O Utility: \_\_\_\_\_ Y-Coord: 53986.5  
Date: 8/6/04 Quad: Whalesville Flood Zone/Coastal: 401.8299 DOT #MISC: 35.00

MAIL TO:  
 WATER SUPPLY SECTION  
 DIVISION OF WATER RESOURCES  
 89 KINGS HIGHWAY  
 DOVER, DELAWARE 19901

STATE OF DELAWARE  
 DEPARTMENT OF NATURAL RESOURCES  
 AND ENVIRONMENTAL CONTROL

http://www.dnrcc.state.de.us/

WELL COMPLETION REPORT  
 MUST BE RETURNED WITHIN 30  
 DAYS OF CONSTRUCTION. A  
 WELL FORMATION LOG MUST BE  
 INCLUDED WITH THIS REPORT.

PHONE: 302-739-3665  
 FAX: 302-739-7764

WELL COMPLETION REPORT

- OFFICIAL USE ONLY -

PAGE 1 OF 2 PAGES

ILLEGIBLE OR INCOMPLETE FORMS WILL BE RETURNED

PLEASE PRINT OR TYPE - USE BLUE OR BLACK INK ONLY

WELL CONSTRUCTION METHOD

Permit # of completed well: 203283w Local ID: \_\_\_\_\_  
 Tax Map/Parcel #: 3-33-11-37.01  
 Property Owner: CHESTER W. DOWNES  
 Water Well Contractor: B&B MECH. WC Lic #: 600  
 Well Driller in Charge during Construction: Steve Delano

Augered  Bored  Cable Tool  
 Driven  Jetted  Air Rotary  
 Mud Rotary  Reverse  Washed  
 Other (Specify): \_\_\_\_\_  
 Total Depth of Excavation: 40'  
 Construction Date: 8/18/04

CASING INSTALLATION:

INNER CASING

OUTER CASING

	(1)	(2)	(3)	(4)	(5)	(6)	
CASING TOP:	<u>8" A</u>	<u>Bouc</u>	<u>Grade</u>				
CASING BOTTOM:	<u>35'</u>						
CASING DIAMETER:	<u>4"</u>						
CASING MATERIAL:	<u>PVC</u>						

SCREEN INSTALLATION

SCREEN TOP:	<u>35'</u>						
SCREEN BOTTOM:	<u>40'</u>						
SCREEN DIAMETER:	<u>4"</u>						
SCREEN MATERIAL:	<u>PVC</u>						

Gravel Pack From: 35 ft. To: 40 ft.  
 Grout Type:  Cement  Bentonite Clay  
 Other: \_\_\_\_\_ From: 0 ft. To: 30 ft.  
 Type of Non-Grout backfill of Well Annulus: SAND  
 From: 30 To: 35  
 Static Water Level: 1'8" ft.  Below OR  Above Ground Surface  
 On (date): 8/18/04  
 Pumping Water Level: 15 ft. On (date): 8/18/04  
 After: 2 hrs. Pumping at: 30 GPM  
 Was a Geophysical Log Taken?  YES  NO

TYPE OF PERMANENT PUMP INSTALLED:

Pump Manufacturer: N/A  
 Rated Capacity (GPM): N/A  
 Pump Intake Setting: \_\_\_\_\_ Ft. Below Ground Surface:  
 Pump Installed By: \_\_\_\_\_ On (date): \_\_\_\_\_

The location and construction of this well is in Compliance with all permit conditions and all applicable well construction regulations.

YES  NO

If "NO," attach a copy of the approved well permit showing the revised location clearly marked.

COMMENTS: WELL WAS PLACED  
10' X 10' OFF RIGHT REAR  
PROP. CORNER

WELL HEAD COMPLETION:

Type:  Pitless Adapter  Standard "T"  
 Well Pit  Pad Mount  
 Other - Specify: CAPPED  
 Well Head Completed: 8 inches  Above (OR)  Below Ground Surface

Was the Well Tag attached in accordance with current regulations?

YES  NO If "NO," Please Explain: NO TAG

WHEN DRILLED RECEIVED

AUG 24

WATER SUPPLY

I HEREBY AFFIRM THE INFORMATION I HAVE SUBMITTED IS ACCURATE AND CORRECT.

Signature - Well Driller in Charge of Well Construction

723 License #

8/20/04 Date

