

38597

CAUTION MUST BE  
OBTAINED AND PERMIT  
OBTAINED BEFORE DRILLING  
OPERATED.

Job 77 Year  
WKS-  
HOB No. 14  
HOB No.

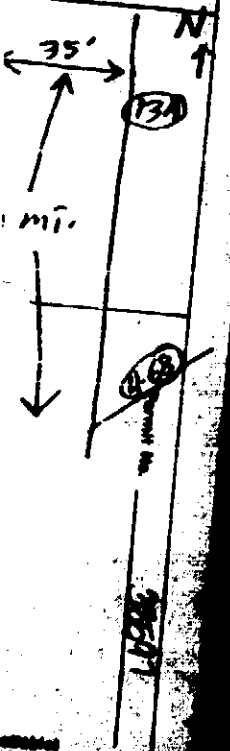

# Delmarva Drilling Co., Inc.

TELEPHONE 286/287-2284

P. O. BOX 188

BRIDGEVILLE, DELAWARE 19922

## Water Well Contractors

CUSTOMER James Christenson Perm # 38597 Job 3901  
ADDRESS Laurel, Del. DATE 7/22/77  
LOCATION 20' N. of drive, 15' E. of house

GROUND	FEET FROM GROUND SURFACE		WELL LOG
	0 TO	.....	
	0-12		tan sand & white clay
	12-23		fine-coarse white
	23-36		fine-med tan sand
	36-53		fine-coarse tan sand
	53-60		fine-gray sand & clay
<b>Qd11-03</b>			

WELL NO. <u>1</u>	DIAMETER OF WELL <u>4"</u>	DEPT. OF WELL <u>50'</u>
MRS. PUMPED <u>2</u>	SLOT SIZE <u>.016</u>	TYPE OF CASING <u>PVC</u>
CAPACITY G.P.M. <u>30</u>	DRILLING MACHINE NO. <u>D-5</u>	LENGTH OF CASING <u>45'</u>
STATIC LEVEL <u>8.1</u>	DRILLER <u>Cornhill</u>	DISTANCE TO TOP OF SCREEN <u>45'</u>
PUMPING LEVEL <u>25'</u>	GRAVEL <u>Worle # 2</u>	TYPE SCREEN <u>PVC</u>
SPECIFIC CAPACITY <u>2</u>	BAGS OF CEMENT	SIZE OF SCREEN <u>48</u>
PUMPED WITH <u>PUMPE</u>	DATE WELL COMPLETED <u>7/22/77</u>	
DEPTH OF CEMENT SPOUT	DRILLER'S HELPER <u>Whitelock</u>	
DEPTH GRAVEL PACKED <u>40-38</u>		

Bill Cornhill  
WELL DRILLER SIGNATURE